

# SCA

## ARCHITECTURAL BASEBOARD



## PERIMETER HEATING WITH STYLE

Architectural in design, the SCA draft barrier is an excellent choice for complementary, perimeter heating. Office buildings will benefit from what the SCA has to offer: a low-profile design capable of efficiently heating perimeter, glassed surfaces. The SCA offers a wide range of installation possibilities and is custom-made for office spaces and adaptable to their future interior layouts. Available in white, soft white and other colours upon request, the SCA can blend in anywhere.

### PERFECT FOR PUBLIC PLACES

SCHOOLS, SHOPPING MALLS,  
HOSPITALS, ETC.

### OFFERED IN THREE WATT DENSITIES

BLANK SECTIONS AVAILABLE  
FOR A CONTINUOUS LOOK

### COLOURS

- **standard:** white, soft white
- **Orora (optional):** refer to [www.stelpro.com/en-CA/Orora](http://www.stelpro.com/en-CA/Orora)

### FINISH

- epoxy-polyester powdercoat

### MANUFACTURING

- 18-gauge steel cabinet and 16-gauge steel front panel
- front air intake and top air discharge
- thermal protection with automatic reset
- full-length wireway

### ELEMENT

- single tubular, stainless steel sheathed element with boxed aluminum fins for improved heat dissipation; the element is securely fastened at its centre, floating in nylon sleeves at each end, eliminating expansion and contraction noises

### CONTROL

- wall thermostat (not included) – the use of an electronic thermostat is strongly recommended
- built-in tamper-proof thermostat accessible without removing front grille, installed in the left junction box only (optional)
- low voltage relay kit installed in the left or right junction box (optional)

### INSTALLATION

- surface mounted
- wall or floor mounted with or without pedestal kit (optional)
- wiring compartments at both ends of unit
- blank sections (custom lengths) and accessories are available for a continuous look (optional)

### WARRANTY

- three years

### IDEAL FOR:

school, shopping mall, hospital

# °STELPRO

Stelpro reserves the right to modify descriptions, manufacturing specifications or prices without prior notice. **No returns accepted on optional-colour products.** For all the latest models and prices, please refer to our website at [www.stelpro.com](http://www.stelpro.com).



FC\_SCA\_EN\_190822

# TECHNICAL SPECIFICATIONS

DENSITY OF 250 W PER LINEAR FOOT		DENSITY OF 200 W PER LINEAR FOOT		DENSITY OF 150 W PER LINEAR FOOT		VOLTAGE	LENGTH		WEIGHT		PRICE
CODE	WATTS	CODE	WATTS	CODE	WATTS	VOLTS	MM	IN.	KG	LB	
SCA6051	500	SCA6041	400	SCA6031	300	120	600	23 5/8	4.1	9	394.00
SCA6058	500	SCA6048	400	SCA6038	300	208	600	23 5/8	4.1	9	394.00
SCA6052	500	SCA6042	400	SCA6032	300	240	600	23 5/8	4.1	9	394.00
SCA6053	500	---	400	---	300	347	600	23 5/8	4.1	9	394.00
---	500	---	400	---	300	600	600	23 5/8	4.1	9	---
SCA9071	750	SCA9061	600	SCA9041	450	120	900	35 7/16	9.1	13	456.00
SCA9078	750	SCA9068	600	SCA9048	450	208	900	35 7/16	9.1	13	456.00
SCA9072	750	SCA9062	600	SCA9042	450	240	900	35 7/16	9.1	13	456.00
SCA9073	750	SCA9063	600	SCA9043	450	347	900	35 7/16	9.1	13	456.00
SCA9076	750	---	600	---	450	600	900	35 7/16	9.1	13	456.00
SCA12101	1000	SCA12081	800	SCA12061	600	120	1200	47 1/4	8.0	17	516.00
SCA12108	1000	SCA12088	800	SCA12068	600	208	1200	47 1/4	8.0	17	516.00
SCA12102	1000	SCA12082	800	SCA12062	600	240	1200	47 1/4	8.0	17	516.00
SCA12103	1000	SCA12083	800	SCA12063	600	347	1200	47 1/4	8.0	17	516.00
SCA12106	1000	SCA12086	800	---	600	600	1200	47 1/4	8.0	17	516.00
SCA15121	1250	SCA15101	1000	SCA15071	750	120	1500	59 1/16	9.0	20	580.00
SCA15128	1250	SCA15108	1000	SCA15078	750	208	1500	59 1/16	9.0	20	580.00
SCA15122	1250	SCA15102	1000	SCA15072	750	240	1500	59 1/16	9.0	20	580.00
SCA15123	1250	SCA15103	1000	SCA15073	750	347	1500	59 1/16	9.0	20	580.00
SCA15126	1250	SCA15106	1000	SCA15076	750	600	1500	59 1/16	9.0	20	580.00
SCA18151	1500	SCA18121	1200	SCA18091	900	120	1800	70 7/8	11.0	25	640.00
SCA18158	1500	SCA18128	1200	SCA18098	900	208	1800	70 7/8	11.0	25	640.00
SCA18152	1500	SCA18122	1200	SCA18092	900	240	1800	70 7/8	11.0	25	640.00
SCA18153	1500	SCA18123	1200	SCA18093	900	347	1800	70 7/8	11.0	25	640.00
SCA18156	1500	SCA18126	1200	SCA18096	900	600	1800	70 7/8	11.0	25	640.00
---	1750	SCA21141	1400	SCA21101	1050	120	2100	82 11/16	13.0	29	702.00
SCA21178	1750	SCA21148	1400	SCA21108	1050	208	2100	82 11/16	13.0	29	702.00
SCA21172	1750	SCA21142	1400	SCA21102	1050	240	2100	82 11/16	13.0	29	702.00
SCA21173	1750	SCA21143	1400	SCA21103	1050	347	2100	82 11/16	13.0	29	702.00
SCA21176	1750	SCA21146	1400	SCA21106	1050	600	2100	82 11/16	13.0	29	702.00
---	2000	---	1600	SCA24121	1200	120	2400	94 1/2	16.0	34	763.00
SCA24208	2000	SCA24168	1600	SCA24128	1200	208	2400	94 1/2	16.0	34	763.00
SCA24202	2000	SCA24162	1600	SCA24122	1200	240	2400	94 1/2	16.0	34	763.00
SCA24203	2000	SCA24163	1600	SCA24123	1200	347	2400	94 1/2	16.0	34	763.00
SCA24206	2000	SCA24166	1600	SCA24126	1200	600	2400	94 1/2	16.0	34	763.00
---	2250	---	1800	---	1350	120	2700	106 5/16	17.0	37	---
SCA27228	2250	SCA27188	1800	SCA27138	1350	208	2700	106 5/16	17.0	37	825.00
SCA27222	2250	SCA27182	1800	SCA27132	1350	240	2700	106 5/16	17.0	37	825.00
SCA27223	2250	SCA27183	1800	SCA27133	1350	347	2700	106 5/16	17.0	37	825.00
SCA27226	2250	SCA27186	1800	SCA27136	1350	600	2700	106 5/16	17.0	37	825.00
---	2500	---	2000	---	1500	120	2700	106 5/16	17.0	37	---
SCA27258	2500	SCA27208	2000	SCA27158	1500	208	2700	106 5/16	17.0	37	825.00
SCA27252	2500	SCA27202	2000	SCA27152	1500	240	2700	106 5/16	17.0	37	825.00
SCA27253	2500	SCA27203	2000	SCA27153	1500	347	2700	106 5/16	17.0	37	825.00
SCA27256	2500	SCA27206	2000	SCA27156	1500	600	2700	106 5/16	17.0	37	825.00

Add W for white or SW for soft white (consult the optional colours chart or contact your Stelpro representative for all other colours).

Models also available in 277 V and 480 V.

--- not available



## ACCESSORIES

PRODUCT	DESCRIPTION	PRICE
<b>SCAT12*</b>	built-in tamper-proof single pole thermostat	<b>166.00</b>
<b>SCAT22*</b>	built-in tamper-proof double pole thermostat	<b>278.00</b>
<b>SCARE153*</b>	built-in electronic low voltage relay [15 A @ 120 V-347 V]	<b>105.00</b>
<b>SCARE156*</b>	built-in electronic low voltage relay [6 A @ 600 V]	<b>164.00</b>
<b>SCARE153T*</b>	built-in electronic low voltage relay c/w transformer 24 V [15 A @ 208 V-347 V]	<b>129.00</b>
<b>SCARM240T*</b>	built-in electromechanical relay c/w transformer 24 V [6000 W @ 240 V and 5200 W @ 208 V]	<b>143.00</b>
<b>SCARM347T*</b>	built-in electromechanical relay c/w transformer 24 V [6000 W @ 347 V]	<b>158.00</b>
<b>SCARM347C*</b>	built-in electromechanical relay w/o transformer 24 V [6000 W @ 120 V-347 V]	<b>120.00</b>
<b>SCAR841D1036*</b>	built-in electromechanical relay w/o transformer 24 V [6000 W @ 600 V]	<b>211.00</b>
<b>SCAR841C1151*</b>	built-in electromechanical low voltage relay c/w transformer 24 V [6000 W @ 600 V]	<b>239.00</b>
<b>PK2*</b>	pedestal kit (kit of two)	<b>154.00</b>
<b>SCAJS*</b>	joiner strip (2 in. – 51 mm)	<b>118.00</b>
<b>SCAIC90*</b>	inside corner (back measures 5 7/8 in. (149 mm) long on each side)	<b>408.00</b>
<b>SCAOC90*</b>	outside corner (back measures 5 7/8 in. (149 mm) long on each side)	<b>408.00</b>
<b>SCACB**</b>	clean back (fully finished, no mounting holes or knockouts)	<b>171.00</b>

Electronic relays can receive a PWM (pulsed width modulation) or digital (on/off) signal.

\* Add W for white or SW for soft white.

\* Factory installed

\* Factory installation is strongly recommended.

## TECHNICAL DRAWINGS

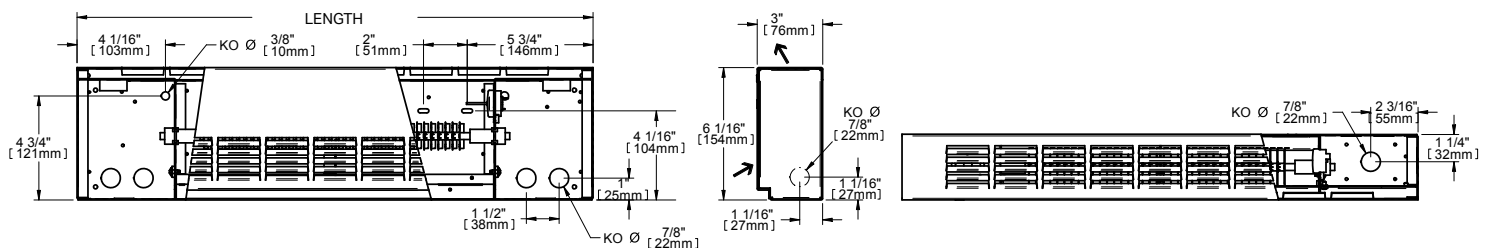

FRONT

SIDE

TOP