

COMMERCIAL & INDUSTRIAL UNIT HEATER

ASHU SERIES

THE POWER OF DISPERSION

°STELPRO designs heaters for all circumstances. Take the ASHU, the large volume heater that is distinguished by its appealing appearance, its manufacturing and its sturdy composition. It is usually installed in large garages, but it is not uncommon for it to be seen in warehouses or any other kind of commercial construction site requiring a generous volume of heat. The ASHU works with great ease and has an incredible power scale from 2 kW to 60 kW. What could be better!



INSTANT HEAT

PERMANENTLY LUBRICATED MOTOR

WIDE RANGE OF POWER: 2 KW TO 60 KW

THERMALLY PROTECTED

WALL OR CEILING INSTALLATION

BRACKET INCLUDED

IDEAL FOR:

WAREHOUSE, FACTORY, INDOOR PARKING GARAGE, LARGE INDUSTRIAL AND COMMERCIAL AREAS

COLOR

almond

FINISH

epoxy-polyester powdercoat

MANUFACTURING

- heavy-duty, 18-gauge steel cabinet
- adjustable louvers and protective screen
- thermal protection with automatic reset

MOTOR

permanently enclosed lubricated ball bearing motor for long-lasting operation

ELEMENT

nichrome element produces instant heat

CONTROL

connection of multiple units to the same thermostat is possible with a relay kit without transformer (optional) and an external transformer (not provided)

INSTALLATION

- wall or ceiling mounted with universal mounting bracket (included)
- minimum distance from adjacent walls: 6 in. (2 kW to 30 kW units), 12 in. (40 kW to 60 kW units)
- maximum mounting heights: 8 ft. (2 kW to 10 kW units), 10 ft. (15 kW to 30 kW units), 15 ft. (40 kW to 60 kW units)

ACCESSORIES

PRODUCT	DESCRIPTION
SHUT1	built-in single pole thermostat (capillary)
SHUT2	built-in double pole thermostat (capillary)
SHUFS*	fan switch
SHUDIS*	disconnect switch [80 A]
SHUC24RX*	relay kit without transformer 24 V
SHUFS-RCV	remote control circuit for ventilation mode 240 V

* Factory installed

TECHNICAL SPECIFICATIONS

WITHOUT CONTROL	BUILT-IN THERMOSTAT	240 V CONTROL	24 V CONTROL	VOLTS	KW	CFM
ASHU0281	ASHU0281T	ASHU0281C	ASHU0281C24	208	2	250
---	ASHU0283CT*	ASHU0283C*	ASHU0283C24*	208	2	250
ASHU0221	ASHU0221T	ASHU0221C	ASHU0221C24	240	2	250
ASHU0271	ASHU0271T	ASHU0271C	ASHU0271C24	277	2	250
---	ASHU0251CT	ASHU0251C	ASHU0251C24	480	2	250
---	ASHU0253CT*	ASHU0253C*	ASHU0253C24*	480	2	250
ASHU0381	ASHU0381T	ASHU0381C	ASHU0381C24	208	3	250
---	ASHU0383CT*	ASHU0383C*	ASHU0383C24*	208	3	250
ASHU0321	ASHU0321T	ASHU0321C	ASHU0321C24	240	3	250
ASHU0371	ASHU0371T	ASHU0371C	ASHU0371C24	277	3	250
---	ASHU0351CT	ASHU0351C	ASHU0351C24	480	3	250
---	ASHU0353CT*	ASHU0353C*	ASHU0353C24*	480	3	250
ASHU0481	ASHU0481T	ASHU0481C	ASHU0481C24	208	4	250
---	ASHU0483CT*	ASHU0483C*	ASHU0483C24*	208	4	250
ASHU0421	ASHU0421T	ASHU0421C	ASHU0421C24	240	4	250
ASHU0471	ASHU0471T	ASHU0471C	ASHU0471C24	277	4	250
---	ASHU0451CT	ASHU0451C	ASHU0451C24	480	4	250
---	ASHU0453CT*	ASHU0453C*	ASHU0453C24*	480	4	250
---	ASHU0581T	ASHU0581C	ASHU0581C24	208	5	450
---	ASHU0583CT*	ASHU0583C*	ASHU0583C24*	208	5	450
ASHU0521	ASHU0521T	ASHU0521C	ASHU0521C24	240	5	450
ASHU0571	ASHU0571T	ASHU0571C	ASHU0571C24	277	5	450
---	ASHU0551CT	ASHU0551C	ASHU0551C24	480	5	450
---	ASHU0553CT*	ASHU0553C*	ASHU0553C24*	480	5	450
---	ASHU0781CT	ASHU0781C	ASHU0781C24	208	7.5	700
---	ASHU0783CT*	ASHU0783C*	ASHU0783C24*	208	7.5	700
---	ASHU0721CT	ASHU0721C	ASHU0721C24	240	7.5	700
---	ASHU0771CT	ASHU0771C	ASHU0771C24	277	7.5	700
---	ASHU0751CT	ASHU0751C	ASHU0751C24	480	7.5	700
---	ASHU0753CT*	ASHU0753C*	ASHU0753C24*	480	7.5	700

* Three-phase unit that can be field-converted to a single phase unit
 * Three-phase unit
 --- not available

THROW DISTANCE AND HEAT RISE

UNITS	THROW DISTANCE		HEAT RISE	
	KW	M	FT.	°C
2	8.5	28	17	31
3	8.5	28	35	62
4	8.5	28	52	93
5	9.4	31	55	99
7.5	9.4	31	54	97
10	9.4	31	85	153
15	10.7	35	52	93
20	11.3	37	89	160
25	10.2	33'6"	133	240
30	10.7	35	135	243
40	10.7	35	132	237
50	10.7	35	141	254
60	10.7	35	156	280

TECHNICAL SPECIFICATIONS

BUILT-IN THERMOSTAT	240 V CONTROL	24 V CONTROL	VOLTS	KW	CFM
ASHU1081CT	ASHU1081C	ASHU1081C24	208	10	700
ASHU1083CT*	ASHU1083C*	ASHU1083C24*	208	10	700
ASHU1021CT	ASHU1021C	ASHU1021C24	240	10	700
ASHU1071CT	ASHU1071C	ASHU1071C24	277	10	700
ASHU1051CT	ASHU1051C	ASHU1051C24	480	10	700
ASHU1053CT*	ASHU1053C*	ASHU1053C24*	480	10	700
ASHU1581CT	ASHU1581C	ASHU1581C24	208	15	1300
ASHU1583CT*	ASHU1583C*	ASHU1583C24*	208	15	1300
ASHU1521CT	ASHU1521C	ASHU1521C24	240	15	1300
ASHU1571CT	ASHU1571C	ASHU1571C24	277	15	1300
ASHU1551CT	ASHU1551C	ASHU1551C24	480	15	1300
ASHU1553CT*	ASHU1553C*	ASHU1553C24*	480	15	1300
ASHU2081CT	ASHU2081C	ASHU2081C24	208	20	1300
ASHU2083CT*	ASHU2083C*	ASHU2083C24*	208	20	1300
ASHU2021CT	ASHU2021C	ASHU2021C24	240	20	1300
ASHU2071CT	ASHU2071C	ASHU2071C24	277	20	1300
ASHU2051CT	ASHU2051C	ASHU2051C24	480	20	1300
ASHU2053CT*	ASHU2053C*	ASHU2053C24*	480	20	1300
ASHU2583CT*	ASHU2583C*	ASHU2583C24*	208	25	1300
ASHU2553CT*	ASHU2553C*	ASHU2553C24*	480	25	1300
ASHU3083CT*	ASHU3083C*	ASHU3083C24*	208	30	1400
ASHU3053CT*	ASHU3053C*	ASHU3053C24*	480	30	1400
ASHU4053CT*	ASHU4053C*	ASHU4053C24*	480	40	2100
ASHU5053CT*	ASHU5053C*	ASHU5053C24*	480	50	2100
ASHU6053CT*	ASHU6053C*	ASHU6053C24*	480	60	2100

2 KW TO 10 KW UNITS

weight: approx. 40 lb (18 kg)

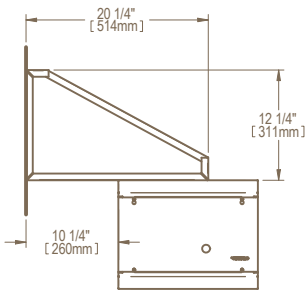

LEFT SIDE

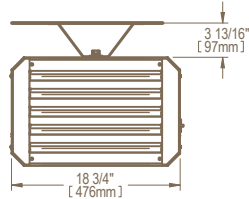

FRONT

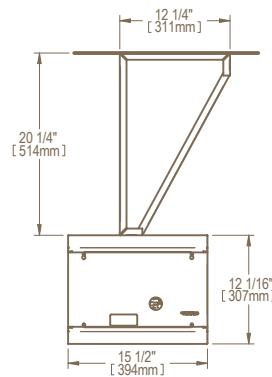

RIGHT SIDE

15 KW TO 30 KW UNITS

weight: approx. 67 lb (30 kg)

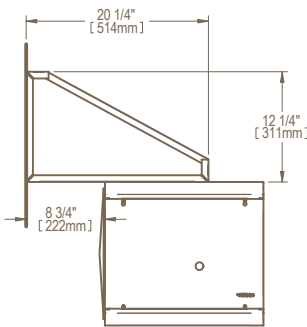

LEFT SIDE

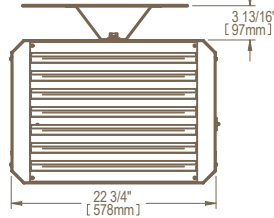

FRONT

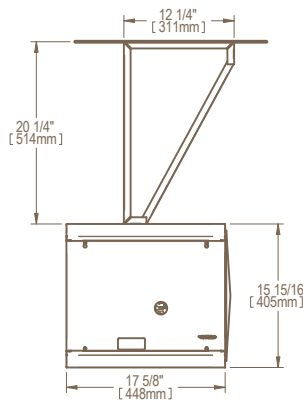

RIGHT SIDE

40 KW TO 60 KW UNITS

weight: approx. 100 lb (45 kg)

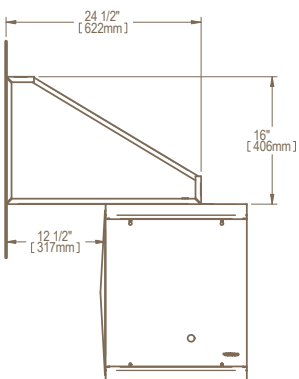

LEFT SIDE

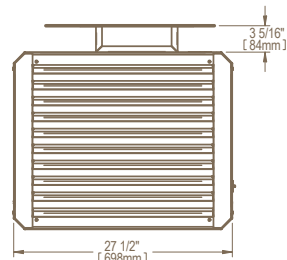

FRONT

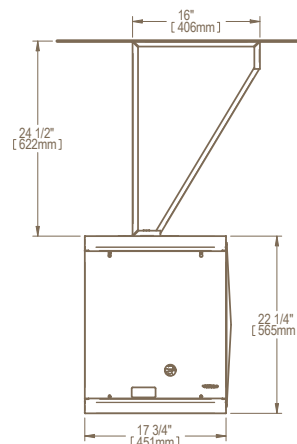

RIGHT SIDE

