

INSTRUCTIONS FOR INSTALLING CIRCULAR LIGHT ENGINE RETROFIT KIT S9782, S9783 & S9784 INTO AN EXISTING FIXTURE



PREPARATION:

Identify and Inspect all parts before beginning installation. Confirm that all parts are present.

If any parts are missing or damaged, do not attempt the retrofit. Contact Satco customer service for questions or replacement parts. Please Call: 1-800-437-2826

TOOLS REQUIRED:

Flathead Screwdriver

Phillips Screwdriver

Pliers

Wire Cutter

Wire Stripper

Electrical Tape

Safety Glasses

Screw Gun with a P1 (small) Phillips Driver (ONLY FOR TYPE "C" INSTALLATION)

PACKAGE CONTENTS:

- A) (1) circular light engine
- B) (6) small wire nuts
- C) (6) medium wire nuts
- D) (1) lock-down retaining ring & washer
- E) (3) 1" #4 screws
- F) (4 x 2 each) Assorted snap-in grommets
(Install grommets where supply wires enter fixture for power).
- G) Wiring diagram

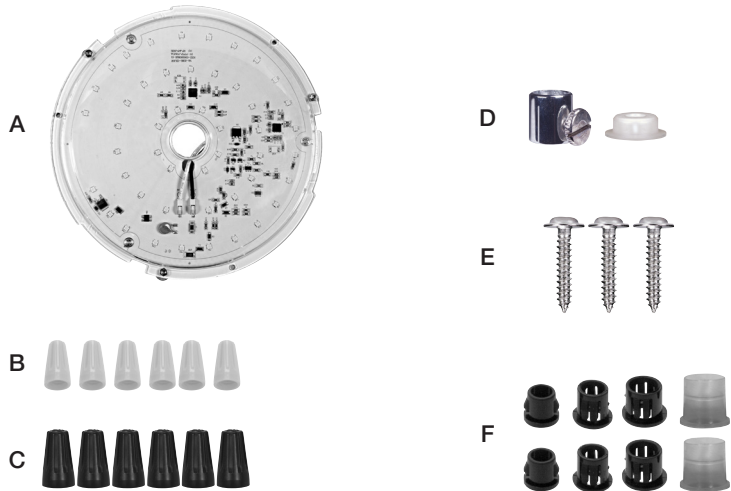

WARNINGS AND CAUTIONS:

WARNING – Turn off Electricity at Circuit Breaker or Main Fuse Box before Installation. The LED Circular Light Engine is rated for standard line voltage (120V). Please confirm voltage before installation. We strongly recommend that a licensed professional electrician perform the installation. These instructions were provided for your safety. Please read them completely before installing the LED Light Engine.

WARNING – Risk of fire or electric shock. LED Retrofit Kit installation requires knowledge of luminaires electrical systems. If not qualified, do not attempt installation. Contact a qualified electrician.

WARNING - Risk of fire or electric shock. Install this luminaires that have the construction features and dimensions shown in the photographs and drawings.

WARNING – To prevent wiring damage or abrasion, do not expose wiring to edges of sheet metal or other sharp objects.

FIXTURE TYPE (A):

A decorative cap or nut secures the diffuser (shade) to the fixture on the threaded center pipe.



WARNING – Do not make or alter any open holes in an enclosure of wiring or electrical components during kit installation.

- 1) Remove diffuser (shade) by unscrewing the decorative lock up knob from the pipe.
- 2) Cut/detach supply wires from one socket. Install appropriate grommet where supply wires enter fixture for power. Attach the power feed to the corresponding supply wires using the appropriate wire nuts. Remove socket. (Wiring diagram "B").
- 3) After the power feed connection is made, if there are additional sockets, wires must be cut and securely capped off and taped using the appropriate wire nuts. Remove any sockets, brackets or hardware that may prevent the light engine from seating correctly on the surface of the fixture pan. (Wiring diagram "C").
- 4) Insert the connector at the end of the power feed securely into the light engine, matching the location of the ribs on the power feed with the corresponding slot on the light engine. (Wiring diagram "D").
- 5) Slide the light engine over post, making sure it seats correctly on the surface of the fixture pan and the connected wires are "tucked" neatly under the module.
- 6) Slide the provided rubber washer, metal washer, 1" check ring, and lock down ring over the center post. Secure the assembly against pan with lock down screw on the side of the lock down ring.
- 7) Turn electricity back on from the circuit breaker or main fuse box. Turn on wall switch to test.
- 8) Slide the diffuser back over the center post and secure with knob.

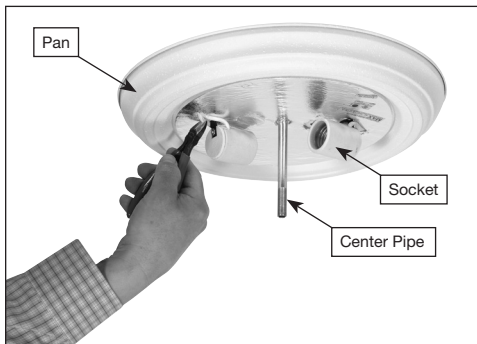
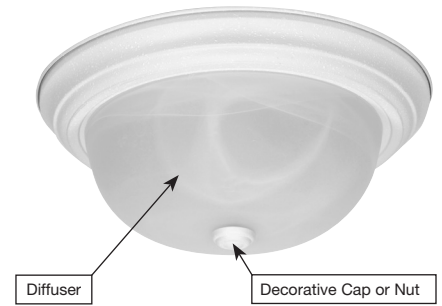

Fig.1

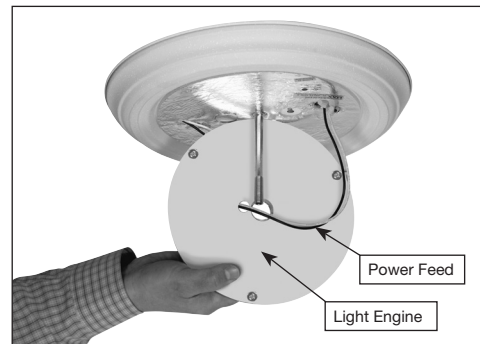

Fig.2

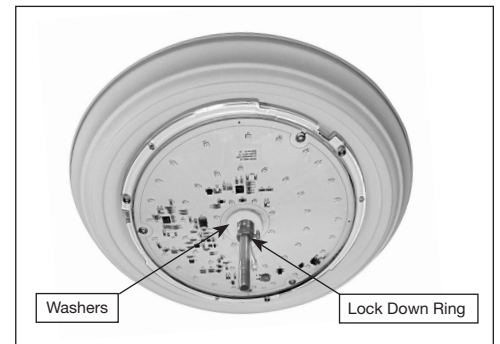

Fig.3

FIXTURE TYPE (B):

For use in totally enclosed fixtures only, that do not have a threaded center pipe and have a flat metal pan, (able to hold magnets).



WARNING – Do not make or alter any open holes in an enclosure of wiring or electrical components during kit installation.

- 1) Remove the diffuser (shade).
- 2) Confirm that the magnet will stick to the metal fixture pan. If the magnet securely adheres to the metal pan, this mounting method is acceptable.
- 4) Follow Steps 2– 4 in “Fixture type A”.
- 5) If there is insulating material at the 6 circular module “leg” placement points, remove insulating material on the inside of the fixture pan so that good contact can be obtained with all the magnets against the fixture pan.
- 6) Center the light engine in the fixture pan making sure all the magnets make contact and securely attach to the fixture pan.
- 7) Turn electricity back on from the circuit breaker or main fuse box. Turn on wall switch to test.
- 8) Replace the diffuser.

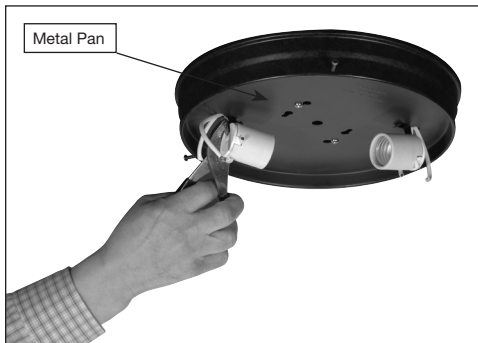

Fig.1

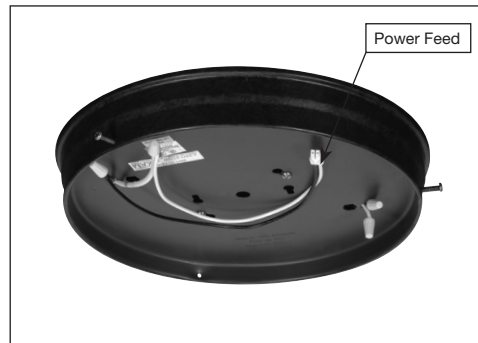

Fig.2



Fig.3



Fig.4

FIXTURE TYPE (C):

For use with non-metallic (not able to hold magnets) fixtures or fixtures with an obstructed or uneven pan and no center threaded pipe.

(A screw gun with a P1 (small) phillips driver is needed for this procedure.)



WARNING – Risk of fire or electric shock. Luminaire wiring and electrical parts may be damaged when drilling for installation of LED retrofit kit. Check for enclosed wiring and components before drilling.

WARNING – Only those open holes indicated in the photographs and drawings may be made or altered as a result of kit installation. Do not leave any other open holes in an enclosure of wiring or electrical components.

- 1) Remove the diffuser (shade).
- 2) Follow Steps 2– 4 in “Fixture type A”.
- 3) Center the circular light engine onto the fixture pan, making sure it is seated evenly with no wire or obstructions under the 3 mounting holes which are located on the perimeter of the circular light engine.
- 4) Slide a self-tapping screw through a hole at the perimeter of the light engine, and using the screw gun carefully screw through the fixture pan , securing the light engine into place (DO NOT OVERTIGHTEN).
- 5) Repeat step 3 for the remaining two holes at the perimeter of the light engine.
- 6) Turn electricity back on from the circuit breaker or main fuse box. Turn on wall switch to test.
- 7) Replace the diffuser.



Fig.1



Fig.2

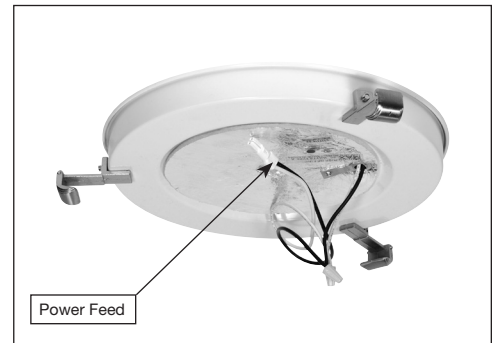

Fig.3

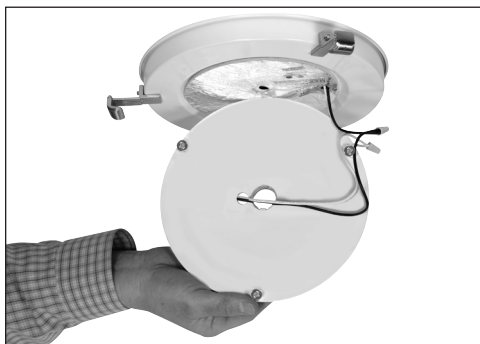

Fig.4

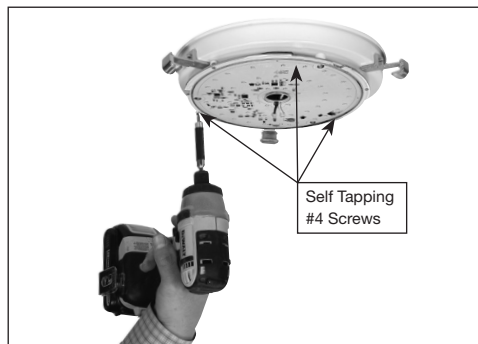

Fig.5



Fig.6



Satco Products Inc. 110 Heartland Blvd., Brentwood, NY 11717

Customer Service Toll Free: 800-437-2826

Fax: 631-243-2027

Email: info@satco.com

