



A CSW Industrials Company

PRODUCT DATA SHEET

FALCON WATER CONNECTIONS

Potable Water Expansion Tanks

Description

Falcon Expansion tanks are designed to protect water heaters from damage caused by thermal expansion. This is a process where water expands as it heats up, creating extra pressure that can cause tanks to burst or leak. Installing a thermal expansion tank is a great way to increase the lifespan of your water heater and prevent costly repairs by helping regulate pressure within the water heater. The 16 gauge cold rolled steel tank used in the construction of these tanks is a robust solution that ensures longevity and durability. In addition, the 100% butyl diaphragm design delivers superior performance and ensures that the tank remains leak-free for the long run.

The factory pre-charge of 40 psi ensures that the thermal expansion tank is ready to use straight out of the box. It is important to note that the tank should not be used over 80 psi. To ensure correct usage, installers must install a pressure reducing valve that will prevent excessive pressure from damaging the tank.

Application

- Absorbs excess pressure created by thermal expansion
- Hot water systems
- Potable water systems only

Recommended Use

- Water Heaters
- Tankless Water Heaters
- Boilers



Characteristics | Features

- 16 gauge cold rolled steel tank
- 100% butyl rubber diaphragm
- Stainless steel Connection
- 100% pressure tested
- Brass air valve with o-ring seal



Approvals

- WQA NSF 61/372
- UPC/IAPMO listed

# FALCON WATER CONNECTIONS

## Potable Water Expansion Tanks

### Packaging

Code	Description	Qty per Case	Lbs per Case	Cubic Feet
Thermal Expansion Tanks				
EXPTMINI	Mini expansion tank	1	1	0.046
EXPT2	Thermal expansion tank - 2.1 gallon	1	5	0.48
EXPT4	Thermal expansion tank - 4.8 gallon	1	9	1.05
EXPT10	Thermal expansion tank - 10.1 gallon	1	16	1.96
EXPT14	Thermal expansion tank - 14.5 gallon	1	27	3.62

**WARNING** • This product can expose you to chemicals including chemicals including Carbon Disulfide, which is known to the State of California to cause cancer, birth defects or other reproductive harm. For more information, go to [www.P65Warnings.ca.gov](http://www.P65Warnings.ca.gov).

Code	A Diameter	B Height	C Connection
EXPTMINI	3.38"	4.45"	1/2" MIP SS
EXPT2	8.00"	12.15"	3/4" MIP SS
EXPT4	11.01"	14.30"	3/4" MIP SS
EXPT10	12.56"	18.70"	3/4" MIP SS
EXPT14	16.06"	22.00"	1" FIP SS

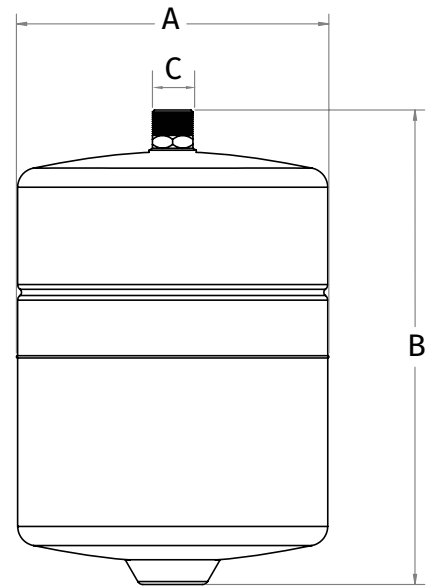
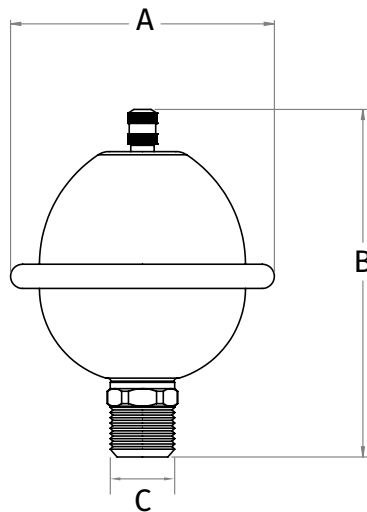

### Limited Warranty



For more information on our product warranty, visit [RectorSeal.com](http://RectorSeal.com)

Manufactured by

**RectorSeal, LLC**

2601 Spenwick Drive, Houston, TX 77055, USA • 800-231-3345 • Fax 800-441-0051 • [rectorseal.com](http://rectorseal.com)

PO Box 5266, Brendale, Qld 4500, Australia • 1300 772 878 • [rectorseal.com.au](http://rectorseal.com.au)

3255 Wyandotte St. East, Windsor, ON N8Y 1E9, Canada • 519-966-4901