



Item#: **55600-8WEM**  
**LED 2X2 SPEC-SELECT™**  
**CENTER BASKET TROFFER**  
 2X2 LUMINARIES FOR AMBIENT LIGHTING OF  
 INTERIOR COMMERCIAL SPACES

**FEATURES**

Spec-Select™ Troffers feature adjustable wattage and color temperature for the perfect balance of light in any application.

- Energy efficient
- No flickering
- 8W emergency battery pre-installed

**APPLICATION**

Ideal for retrofitting inefficient fixtures in malls, hospitals, airports, offices, lobbies and other residential and commercial applications.

PERFORMANCE DATA

**ELECTRICAL**

Wattage	30W / 35W / 40W
Voltage	120-277V
Current	0.33-0.14A
Power Factor	0.9
Total Harmonic Distortion (THD)	10

**LIGHTING PERFORMANCE**

Lumens	3960-5000
Lumens Per Watt (Lm/W)	125
Color Temperature (CCT)	3500K / 4100K / 5000K
Color Rendering (CRI)	82
R9 (Red Value)	7 / 12 / 8
R13 (Skin Tones)	82 / 83 / 83
Beam Angle	100°
Light Distribution	Type VS
BUG Rating (Backlight, Uplight, and Glare)	B2 - U1 - G1
Dimmable Lighting Control	<i>Dimmable</i> 0-10V, Range 10% - 100%

**ENVIRONMENT**

Operating Temperature	-4 ~ 122°F
Suitable Location	<b>DAMP</b>
Ingress Protection Rating	IP40

**LIFESPAN**

Average Life (Hours)	50,000
Warranty (Years)	<b>5</b>

**COMPONENTS**

LED Light Source	Seoul 3528
Driver	SIP50-I850
Emergency Battery	55390

**CONSTRUCTION**

Housing	Aluminum
Lens	Frosted
Base / Power Supply	Hard Wired
Finish	White

**QUALIFICATIONS**



Visit [www.designlights.org/search](http://www.designlights.org/search) to confirm qualification. • Published lumens on LED products are approximate and may vary slightly. • Specifications are subject to change without notice.

Item#: **55600-8WEM**  
**LED 2X2 SPEC-SELECT™ CENTER BASKET TROFFER**



ITEM INFORMATION

**DIMENSIONS** (Inches)

Length	23.8"
Width	23.8"
Height	2.8"
Net Weight (Lbs)	--

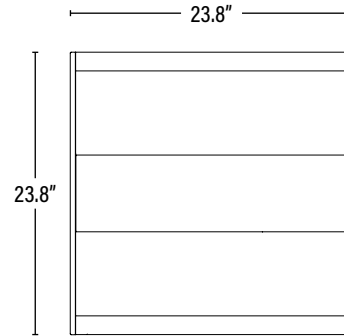

**SUPPORTING DOCUMENTS** (Grey = not available at this time.)

Product Sheet	VIEW
Install Instructions	VIEW
Emergency Battery	VIEW
IES Download from Web Item	VIEW
LM79	VIEW
LM80	VIEW

**PACKAGING**

		UPC	DIMENSIONS (LxWxH)	GROSS WEIGHT (Lbs)
Master Carton	1	811768027235	--	--
Country of Origin	China			
HS Tariff	9405.10.6020			

**ORDERING**

ITEM#	DESCRIPTION	CASE
55600-8WEM	LED 2X2 SPEC-SELECT™ CENTER BASKET TROFFER - 30/35/40W/35-50K/120-277V/DIMMABLE/8W EM BATTERY - SL® DLC®	1

**REPLACEMENT PARTS**

55390	EMERGENCY PACK FOR LED FIXTURE 8W/90 MIN/SPLIT TYPE/L - SL® T20C	1
SIP50-I850	REPLACEMENT LED DRIVER	1

**ADDITIONAL INFORMATION:**

- Default settings; 40W, 5000K.
- When the fixture is in emergency mode the color temperature will default to 5000K.
- The color temperature and wattage may be adjusted by two slide switches integrated into the driver. The color temperature and wattage should be selected prior to installation.

