

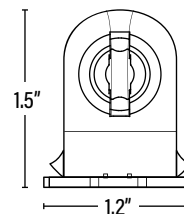

Item#: **54725**
**WIRING HARNESS FOR 2 SINGLE-END
 DIRECT WIRE LED TUBES**
 ACCESSORY

APPLICATION

Non-shunted wiring harness for retrofitting 2 lamps
 fluorescent fixtures to LED Ready for single-end direct
 wire tubes.

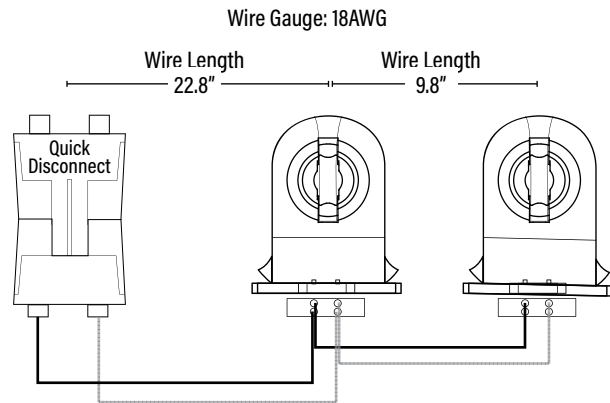

Includes 2 non-wired,
 non-shunted sockets.

PACKAGING		UPC	DIMENSIONS (LxWxH)	GROSS WEIGHT (Lbs)
Master Carton	100	10811768021445	--	--
Individual Item	1	811768021448		
Country of Origin	China			
HS Tariff	9405.99.4090			

ORDERING

ITEM#	DESCRIPTION	CASE
54725	WIRING HARNESS FOR (2) LED T8 TUBES (2) PRE-WIRED NON-SHUNTED AND (2) NON-WIRED SOCKETS W/ QUICK DISCONNECT - SL®	100

GENERAL WIRING DIAGRAM - Follow lamp installation for specific wiring instructions.

⚠ WARNING - Disconnect power before installing or servicing.

