

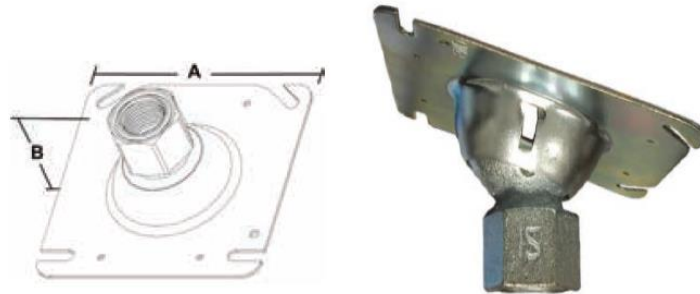

MORRIS CAT#: 18093



Swivel Pendant Malleable Square Fixture Hanger



Features:

- Used to support light fixtures, security cameras, exit signs, and a variety of electrical and electronic devices installed in industrial settings
- Pivot ball that allows the installed fixture and pipe stem to swing 20° from vertical when subjected to occasional bumps or vibration
- Fits 3/4" conduit
- Includes reducer bushing to 1/2" with set screw
- Fits standard 4" Square electrical boxes
- Rated for 50lbs Maximum

DIMENSIONS = INCHES

| CAT. NO. | DIMENSIONS | | BOX QTY |
|-------------|------------|------|------------|
| | A | B | |
| 18093 | 4.21 | 2.02 | 25 |