

Project Name:	Part Number:	Type:
---------------	--------------	-------



# WTX AMAZON

## WET LOCATION VAPOR TIGHT



### FEATURES

- Available in 4ft & 8ft Lengths:
  - Slim Version - 4.4" Wide (WTXS)
  - Wide Version - 7.1" Wide (WTX)
- Continuous poured, closed cell polyurethane gasket
- Fiberglass body attributes:
  - IP65, IP66, IP67 (dust tight, low/high pressure water jets & immerse 1m)
  - NEMA4X, NSF Listed and 5VA Flame Rated
- Smooth Impact Resistant, Acrylic Clear (SACL std.), Acrylic Frosted (SAFL), Polycarbonate Clear (SPCL), Polycarbonate Frosted (SPFL) Lens Options
- Polycarbonate Latches (std.), Stainless Steel (SS) optional
- Tamper Proof Screws (TPS) optional
- Patent Pending Integrated Light Engine Design
- 120-277 Universal Voltage (Non-Dimmable)
- High Efficacy - Up to 138 lm/W
- 4000K & 5000K Color Temperatures
- ETL Listed for Wet Location
- 5 Year Warranty
- DesignLights Consortium® Premium Qualified Luminaire

WTXS

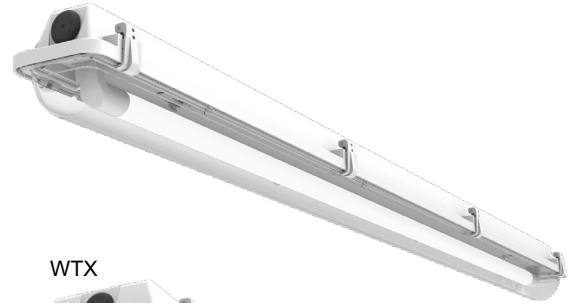

WTX



### SUITABLE APPLICATIONS

- Parking Garage
- Food Processing & Preparation (SS Latches)
- Pool Areas (SS Latches)
- Car Washes (SS Latches)

LED INFO	12W			24W			48W		
Calculated L <sub>70</sub> (TM-21) Hours	WTXS >100K			WTX >100K			WTX8 >100K		
Delivered Lumens	1694 lm			1706 lm			3413 lm		
Total Input Watts	12 W			25 W			49 W		
Luminaire Efficacy Rating (LER)	137 lm/W			138 lm/W			134 lm/W		
Correlated Color Temperature (CCT)	5000K			5000K			5000K		
Color Rendering Index (CRI)	>80			>80			>80		
Ambient Temperature Range	-4°F - 104°F			-4°F - 89°F			-4°F - 86°F		

LED System data above based on WTXS-12W-U-50-SACL, WTX-12W-U-50-SACL, WTX-24W-U-50-SACL, WTX-36W-U-50-SACL, WTX8-24W-U-50-SACL, WTX8-48W-U-50-SACL, WTX8-72W-U-50-SACL  
 LED Lumen maintenance estimates on TM-21 projections for the light source at 25°C ambient.

### ORDERING GUIDE:

Series	Watts	Driver	Color	Options
WTXS Amazon Slim 4ft	12W	U 120-277V Driver	50 40	SACL SAFL SPCL SPFL WLOS BD50 BD30
WTX Amazon 4ft	12W 24W 36W			Smooth Acrylic Clear Lens (std.) Smooth Acrylic Frosted Lens Smooth Polycarbonate Clear Lens Smooth Polycarbonate Frosted Lens On/Off Wet Location Occupancy Sensor 50% Bi-Level Wet Location Dimming Sensor (Available on 24W & 48W Models Only) 30% Bi-Level Wet Location Dimming Sensor (Available on 36W & 72W Models Only) Factory Installed 5W Battery Backup Factory Installed 10W Battery Backup Factory Installed -4 F 10W Cold Temperature Battery Backup Cord (x = ft) 6ft Factory Installed Cord With a L715 Plug Attached (Plug not Wet Listed) Toggle Hanging Loop Cable System (xx = in) 45 Degree Angle Mounting Bracket Stainless Steel Latches Tamper Proof Screws 347V Step Down Transformer 480V Step Down Transformer Surge Protector - 10KVA 120 - 277VAC
WTX8 Amazon 8ft	24W 48W 72W			EM5* EM10* EMCT CORDWx CORDW/6FT/L7-15P

†Not DLC Listed

\*32°F Minimum Starting Temperature

# WTX AMAZON

## WET LOCATION VAPOR TIGHT

### LINE DRAWINGS

**WTXS:**

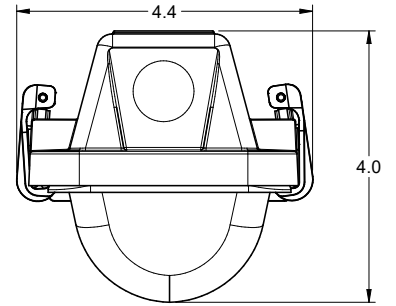
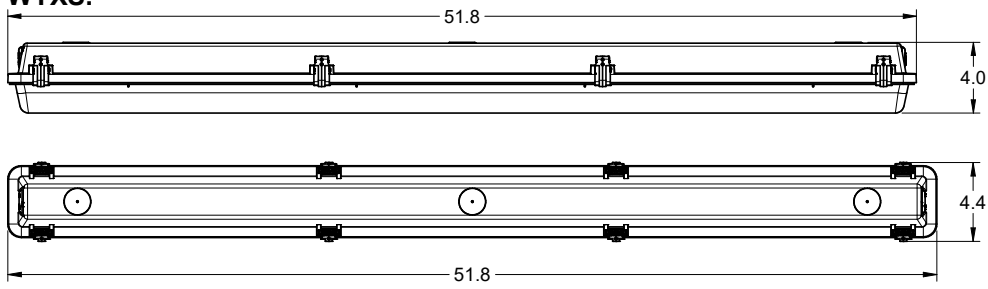

**WTX:**

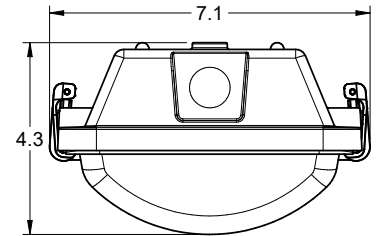
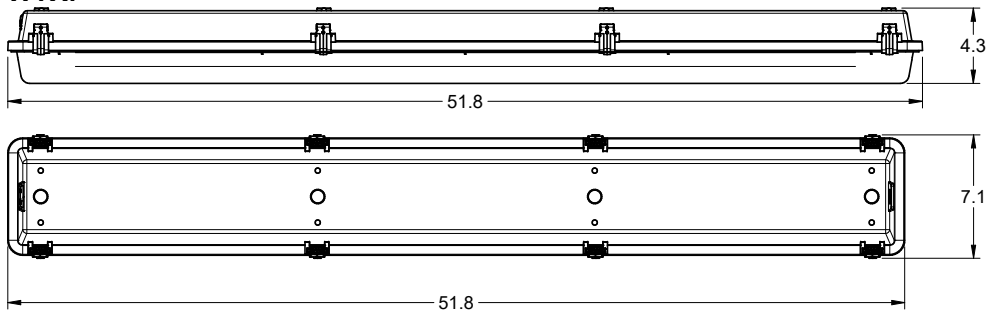

**WTX8:**

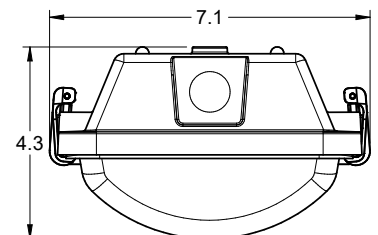
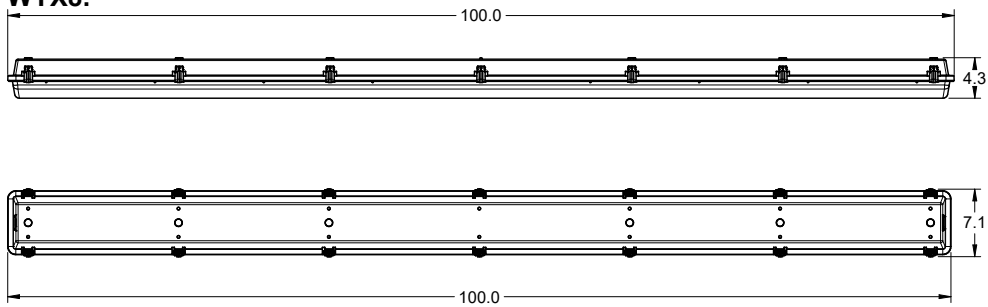

# WTX AMAZON

## WET LOCATION VAPOR TIGHT

### MOUNTING OPTIONS

- **Y-Toggle Cable Kit (HB-XX-LOOP)** - Includes two adjustable cable hangers (xx=in)
- **AB/45DEG** – 45° Degree Angle Mounting Bracket
- **SS MOUNTING BRACKET** – For drill-free surface mounting (2 brackets standard)



HB-XX-LOOP



AB/45DEG



SS Mounting Bracket

### PHOTOMETRIC REPORTS

Photometric values based upon tests performed in compliance w/ LM-79. Download IES files at [www.ilp-inc.com](http://www.ilp-inc.com)

#### WTXS-12W-U-50-SACL

##### SUMMARY DATA

HEMISPHERES TESTED:	BOTH
EFFICIENCY (Downlight):	95.8%
EFFICIENCY (Uplight):	4.2%
CIE CLASSIFICATION:	DIRECT
LUMENS/LAMP:	1694
INPUT WATTS:	12.3579

##### PLANE AND CONE DIAGRAM

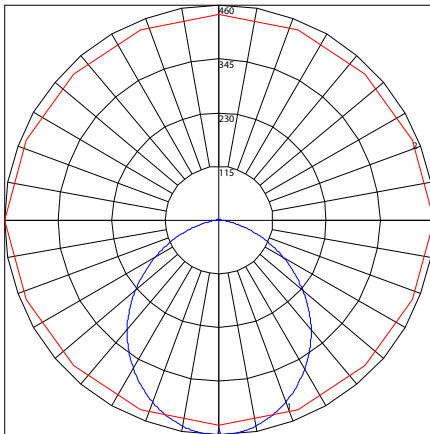

Maximum Candela = 460.2 Located At Horizontal Angle = 0, Vertical Angle = 1  
 # 1 - Vertical Plane Through Horizontal Angles (0-180) (Through Max. Cd.)  
 # 2 - Horizontal Cone Through Vertical Angle (1) (Through Max. Cd.)

#### WTX-12W-U-50-SACL

##### SUMMARY DATA

HEMISPHERES TESTED:	BOTH
EFFICIENCY (Downlight):	95.8%
EFFICIENCY (Uplight):	4.2%
CIE CLASSIFICATION:	DIRECT
LUMENS/LAMP:	1706
INPUT WATTS:	12.33

##### PLANE AND CONE DIAGRAM

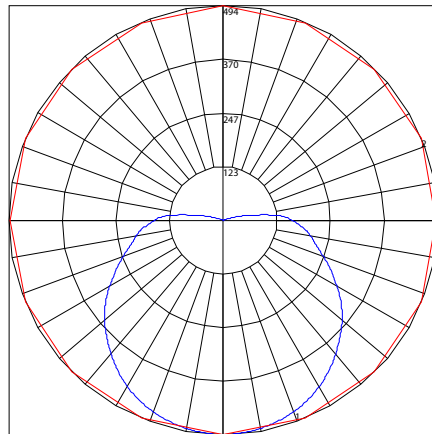

Maximum Candela = 493.9 Located At Horizontal Angle = 90, Vertical Angle = 5  
 # 1 - Vertical Plane Through Horizontal Angles (90-270) (Through Max. Cd.)  
 # 2 - Horizontal Cone Through Vertical Angle (.5) (Through Max. Cd.)

#### WTX-24W-U-50-SACL

##### SUMMARY DATA

HEMISPHERES TESTED:	BOTH
EFFICIENCY (Downlight):	95.8%
EFFICIENCY (Uplight):	4.2%
CIE CLASSIFICATION:	DIRECT
LUMENS/LAMP:	13296
INPUT WATTS:	24.64

##### PLANE AND CONE DIAGRAM

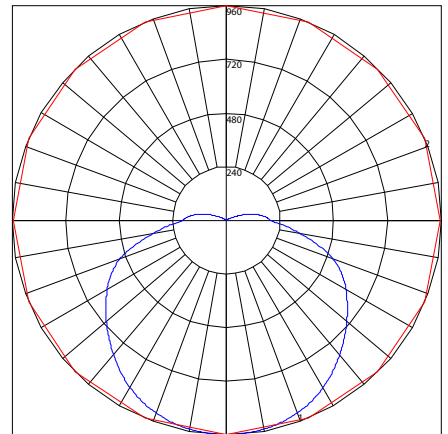

Maximum Candela = 959.7 Located At Horizontal Angle = 90, Vertical Angle = .5  
 # 1 - Vertical Plane Through Horizontal Angles (90-270) (Through Max. Cd.)  
 # 2 - Horizontal Cone Through Vertical Angle (.5) (Through Max. Cd.)

# WTX AMAZON

## WET LOCATION VAPOR TIGHT PHOTOMETRIC REPORTS

Photometric values based upon tests performed in compliance w/ LM-79. Download IES files at [www.ilp-inc.com](http://www.ilp-inc.com)

### WTX-36W-U-50-SACL

#### SUMMARY DATA

HEMISPHERES TESTED:	BOTH
EFFICIENCY (Downlight):	95.8%
EFFICIENCY (Uplight):	4.2%
CIE CLASSIFICATION:	DIRECT
LUMENS/LAMP:	4830
INPUT WATTS:	36.925

#### PLANE AND CONE DIAGRAM

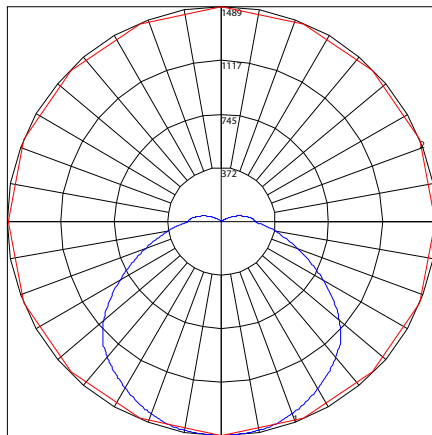

Maximum Candela = 1489 Located At Horizontal Angle = 90, Vertical Angle = 1.5  
# 1 - Vertical Plane Through Horizontal Angles (90 - 270) (Through Max. Cd.)  
# 2 - Horizontal Cone Through Vertical Angle (1.5) (Through Max. Cd.)

### WTX8-24W-U-50-SACL

#### SUMMARY DATA

HEMISPHERES TESTED:	BOTH
EFFICIENCY (Downlight):	95.8%
EFFICIENCY (Uplight):	4.2%
CIE CLASSIFICATION:	DIRECT
LUMENS/LAMP:	3412
INPUT WATTS:	24.7

#### PLANE AND CONE DIAGRAM

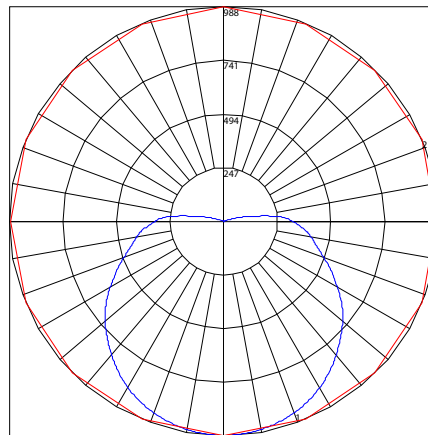

Maximum Candela = 887.8 Located At Horizontal Angle = 90, Vertical Angle = 5  
# 1 - Vertical Plane Through Horizontal Angles (90 - 270) (Through Max. Cd.)  
# 2 - Horizontal Cone Through Vertical Angle (5) (Through Max. Cd.)

### WTX8-48W-U-50-SACL

#### SUMMARY DATA

HEMISPHERES TESTED:	BOTH
EFFICIENCY (Downlight):	95.8%
EFFICIENCY (Uplight):	4.2%
CIE CLASSIFICATION:	DIRECT
LUMENS/LAMP:	6593
INPUT WATTS:	49.16

#### PLANE AND CONE DIAGRAM

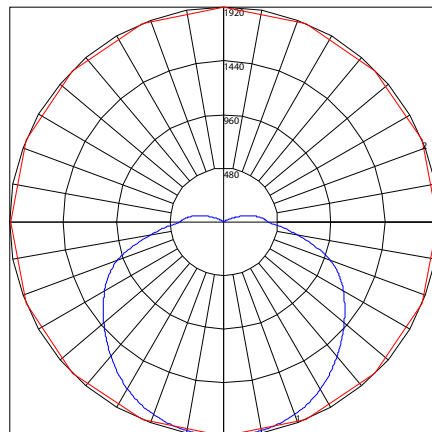

Maximum Candela = 1919.8 Located At Horizontal Angle = 90, Vertical Angle = 5  
# 1 - Vertical Plane Through Horizontal Angles (90 - 270) (Through Max. Cd.)  
# 2 - Horizontal Cone Through Vertical Angle (5) (Through Max. Cd.)

### WTX8-72W-U-50-SACL

#### SUMMARY DATA

HEMISPHERES TESTED:	BOTH
EFFICIENCY (Downlight):	95.8%
EFFICIENCY (Uplight):	4.2%
CIE CLASSIFICATION:	DIRECT
LUMENS/LAMP:	9647
INPUT WATTS:	73.84

#### PLANE AND CONE DIAGRAM

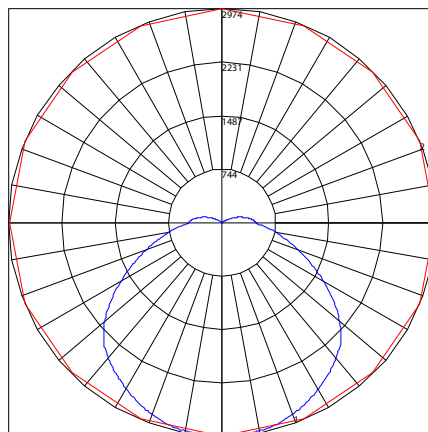

Maximum Candela = 2974 Located At Horizontal Angle = 90, Vertical Angle = 1.5  
# 1 - Vertical Plane Through Horizontal Angles (90 - 270) (Through Max. Cd.)  
# 2 - Horizontal Cone Through Vertical Angle (1.5) (Through Max. Cd.)