

ENDEAVOUR

LINEAR HIGH BAY



407-478-3759
www.ilp-inc.com

FEATURES

- Sleek Curved Polycarbonate Injection Molded End Caps
- Aluminum Body with steel channel for added rigidity
- Toolless Hinged Driver Access
- Wide & Narrow Distributions
- Impact Resistant and IP5X Rated Lens Options:
 - Frosted Acrylic (FRL)
 - Frosted Polycarbonate (PFL) IK10 Impact Rated
- V-Clips for dual point chain or cable hanging (std.)
- Advanced and Basic Controls Options
- -40° F-131° F Ambient Temperature Range
- 3000K-5000K CCT
- Uplight Options
- >80 Color Rendering Index (CRI)
- Calculated L70 >100,000 hrs
- 0-10V Dimmable Driver (100%-10%)
- 120-277V Universal Voltage
- 5 Year Warranty (std); 10 Year Warranty Optional
- ETL Listed for Damp Location
- DesignLights Consortium® Qualified Luminaire



Fixtures shown with Frosted Lens (FRL)



SUITABLE APPLICATIONS

- Gymnasiums
- Manufacturing Plants
- Warehouses
- Distribution Centers

ORDERING GUIDE:

SERIES	LUMENS (select one)		DRIVER	CCT	LENS OPTIONS		DISTRIBUTION		UPLIGHT		FINISH		WARRANTY
EDV	8L ²²	30L	U 120-277V	50	BLANK	No Lens	BLANK	Wide	BLANK	No Uplight	BLANK	White	BLANK 5 Year
Endeavour	12L	36L		40	FRL	Frosted Acrylic	ND	Narrow	UP/2L ^{1,2}	2000lm Uplight	BLK ^{1,9}	Black	10YR ¹⁸ 10 Year
	15L	48L		35	PFL	Frosted			UP/4L ^{1,3}	4000lm Uplight	C ^{1,12}	Custom	
	18L	60L		30		Polycarbonate							
	24L												

OPTIONS		CONTROLS OPTIONS ¹	
Factory Installed		Basic	
CORDx	Cord (x = ft)	FIOS ^{10,13}	On/Off Occupancy Sensor
CORD/XFT/L7-15P	Cord (x=ft) with 277V 15amp Plug	FIOSPC ^{10,13}	On/Off Occupancy Sensor w/ Photocell
QDCx	Quick Disconnect Cord (x = ft)	FIOSPC/DLH ^{10,13}	On/Off Occupancy Sensor w/ Daylight Haresting
GTD	Factory Installed Generator Transfer Device	DHPC ^{10,13}	Daylight Harvesting
EM5 ¹⁵	5W LED Factory Installed Battery Backup	USB ^{10,13}	User Bi-Level Dim Sensor w/ Occ. Sensor
EM5/HE ¹⁵	5W LED Factory Installed Battery Backup - CEC Title 20 Compliant	BDxx ^{10,13}	Preset Bi-Level Dim Sensor (xx=%eg.20,30)
EM7 ¹⁵	7W LED Factory Installed Battery Backup	BDxxPC ^{10,13}	Preset Bi-level Dim Sensor w/ Photocell
EM7/HE ¹⁵	7W LED Factory Installed Battery Backup - CEC Title 20 Compliant	CLOS	Cold Location Occupancy Sensor
EM10 ¹⁵	10W LED Factory Installed Battery Backup		
EM10/HE ¹⁵	10W LED Factory Installed Battery Backup - CEC Title 20 Compliant		
EM10/HE-SD ¹⁵	10W Factory Installed Self Diagnostic Battery Backup		
EM12 ¹⁵	12W LED Factory Installed Battery Backup		
EM20 ^{4,5,15}	20W LED Factory Installed Battery Backup - CEC Title 20 Compliant		
EM25 ^{4,5,15}	25W LED Factory Installed Battery Backup		
SD480 ¹	480V Step Down Transformer		
SD347 ¹	347V Step Down Transformer		
Ship With Accessories		Advanced	
WC ¹⁹	11 GA Wire Cage	ES/HB ^{6,10,14}	EasySense High Bay Sensor
FMB/EDV ¹⁶	Fixture Mounting Box	FSP-311/L2 ¹¹	Legrand FSP-311 Bluetooth Programming Sensor – 8' Mounting Height
HUB 3/4 ¹⁷	Conduit Hub ¾" for pendant mount	FSP-311/L3 ¹¹	Legrand FSP-311 Bluetooth Programming Sensor – 20' Mounting Height
HOOK	Cast Iron Hook for single point mounting	FSP-311/L7 ¹¹	Legrand FSP-311 Bluetooth Programming Sensor – 40' Mounting Height
HB-XX-18Y-PAD	Y-Toggle Cable System (xx = in)	5S/CU/IL ^{11,15}	Enlighted 5E Individual Lighting (IL) Sensor with Control Unit
SMZBKIT/EDV	Surface Mount Bracket	5S/CU/CL ^{11,15}	Enlighted 5E Connected Lighting (CL) Sensor with Control Unit
ES/PCD ⁷	EasySense Pre-Programmed Control Device	5S/CU/IOT ^{11,15}	Enlighted 5E Internet of Things (IOT) Sensor with Control Unit
ES/IR ⁸	EasySense Commissioning IR Blaster	ZLD1Z ¹¹	Leviton ZLD1Z 120-277V Bluetooth Groupable Sensor (16 Devices) with 8-20' & 20-40' lens included
ES/WWS/DR	EasySense Dual Rocker Wireless Wall Switch	SYN ²⁰	Synapse Control System
		SYNS/LX ^{20,21}	Synapse Control System w/ Sensor (X = Mounting Height 3=10-20', 7=20-40')

¹ Refer to DLC for listing ⁶ Must be used w/ ES/PCD and ES/IR options for commissioning ¹⁰ Sensor Mounted off end cap of fixture ¹⁵ Operation down to 32°F ²⁰ Contact Factory for Site Layout
² Available for EDV-8L-24L only ⁷ One needed per project ¹¹ Sensor Mounted on center driver channel ¹⁶ Must use w/ HUB 3/4 for Pendant Mounting ²¹ Center Mounted Sensor
³ Available for EDV-30L-60L only ⁸ Must be used with ES/PCD ¹² Consult Factory ¹⁷ Must use w/ FMB/EDV for Pendant Mounting ²² Operation down to -4F
⁴ Cannot be used w/ FMB, HUB, or HOOK ⁹ Reduces published performance by 16% ¹³ Operation down to 14°F ¹⁸ Contact Factory for more details ¹⁹ Does Not Qualify for DLC
⁵ Mounted externally to fixture

SPECIFICATIONS

CONSTRUCTION

Aluminum body with steel driver channel for maximum rigidity and thermal properties. Sleek curved polycarbonate injection molded end caps provide a modern finish while adding rigidity and durability. Toolless hinged driver door access for ease of maintenance and installation. Power access plate mounted on back of center driver channel for easy access to wiring. Product proudly assembled in the United States of America.

ELECTRICAL

Class 2 LED light engine for high efficacy and long life. Calculated $L_{70} > 100,000$ hrs. LED Lumen Maintenance Estimates based on TM-21 projections for the light source at 25°C ambient. Power Factor > 0.90 . Standard 120-277 Vac 0-10V dimmable (10%-100%) with optional 347-480 Vac step down transformer. Optional emergency battery backups and generator transfer device available to meet critical life safety lighting requirements. Fixture reduced maximum ambient for emergency battery backup and step down options. Optional uplight wired to sensor it ordered together.

MOUNTING

Options include suspension chain, aircraft cables, hook, single pendant (HUB), surface mount (SMZBKIT). Reduced maximum ambient range for surface mount.

UPLIGHT OPTION

Offers an additional layer of lighting to optimize full room illumination by reducing the contrast between the luminaire and the ceiling, eliminating the "cave" effect. With a dedicated individual switchable 0-10V (10%) dimmable driver and 2 linear strips of LED boards, the modules are encapsulated with a frosted polycarbonate lens and are sealed to an IP5X rating.

OPTICS

Standard without lens. Optional frosted acrylic (FRL) and frosted polycarbonate (PFL) lenses available for added LED protection and glare reduction. Both optics are IP5X rated; protected against dust intrusion. Frosted Polycarbonate lens (PFL) is IK10 Impact Rated; highest impact rating available. Wide (std.) & Narrow (ND) Distribution options available for all lumen packages.

THERMAL

Ambient temperature range -40F up to 131F (-40C to 55C). Reference LED Systems Info for more detail. Fixture to be mounted at a minimum plenum height of 18" to maintain maximum ambient temperature. Reduced maximum ambient for surface mounting.

CONTROLS

Factory installed Advanced and Basic integral occupancy sensor options available. All Basic sensors are end mounted. Advanced EasySense sensor is end mounted. All other Advanced sensors are center driver cover mounted. Inquire with manufacturer for additional controls options, including customer supplied items.

CERTIFICATIONS

ETL listed to US and Canadian safety standards. Suitable for damp locations. American Recovery and Reinvestment Act Funding Compliant. Please refer to the DLC (DesignLights Consortium) Qualified Products List at www.designlights.org/QPL to confirm specific product qualifications.

WARRANTY

5 Year Warranty Standard; 10 Year Warranty Optional ([Terms and Conditions apply](#)).

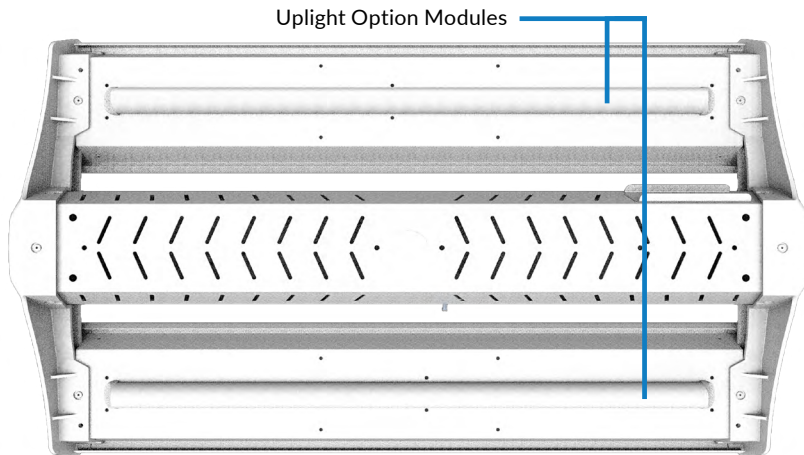

BASIC

FIOS

Standard on/off motion sensor. Comes with 360 degree high bay lens, 360 degree low bay lens & aisle lens. 360 degree high bay lens factory installed, unless notified otherwise. Sensor mounted off end cap of fixture. Inquire for mounting on center of driver cover.

FIOSPC

Motion sensor with the addition of photocell control. When installed, fixture will not activate unless 1. motion is detected and 2. light levels are below the preset level. When activated, fixture will turn on to 100% light output & will only shut off when one of the two levels mentioned above are met. If no motion is detected & light levels fall below preset level the fixture remains off. Sensor mounted off end cap of fixture.

FIOSPC/DLH

Factory installed motion sensor with the addition of photocell control that will allow for daylight harvesting. When installed, fixture will not activate unless 1. motion is detected & 2. light levels are below the preset level. When activated, fixture will turn on only enough to meet the preset light levels and will adjust as the amount of light in the space adjusts between 100%-10%. If light levels are adequate the fixture will remain off. Sensor mounted off end cap of fixture.

ADVANCED

Philips ES/HB

EasySense sensor combines occupancy sensing, daylight harvesting and institutional tuning in one compact solution. This is an ideal control for any high bay application. Each device allows you to turn on/off occupancy and/or daylight harvesting functions as well as set the full light output, background light level, occupancy prolong time, occupancy grace fading time & occupancy time out/hold time. Requires use of EasySense Pre-Programmed Control Device (ES/PCD) & Commissioning IR Blaster (ES/IR); one of each needed per project. (Sold separately). Sensor mounted off end cap of fixture.

Leviton ZLD1Z

Optional Bluetooth Groupable PIR sensor that allows for Programmable Options such as, Continuous Dimming, Motion and/ or daylight harvesting, fully adjustable high/low dimmed light levels, and Adjustable time delay/ cutoff delay. The sensor is programmed via a free iOS® or Android® Sensor Configuration App (compatible device provided by others). Sensor Mesh Grouping allows for 16 devices per group, with both Occupancy and Daylight Control. Recommended spacing < 100'. Comes standard with both 8'-20' or 20'-40' mounting lenses. Comes standard with Optional Masks for Aisle Way distributions.

Default Settings

- High Mode: 100% Output
- Auto-ON/Auto-OFF with 20-minute timeout
- Sensitivity: High
- Daylight Harvesting: Enabled

Synapse

Utilizing a robust 2.4 GHz Self-Healing Mesh Network, Synapse provides flexibility and scalability making it a perfect industrial solution for both new construction and retrofit projects. The easy-to-use web application is accessible on any device with an internet connection and allows for complete customization of the system and its features. Integral radio (SYN) includes (2) 24V inputs for a Wattstopper sensor. Sensors available in 20' or 40' mounting lenses. See coverage patterns below. Sensor mounted on hinged driver cover. Antenna exits side of luminaire for maximum connectivity.

USBD

User Selectable Bi-Level Dimming. Allows the end user to manually select the unoccupied dimming level. Once motion is detected, the fixture will return to 100% light output. Sensor mounted off end cap of fixture.

BDxx

Factory set Bi-Level Dimming. Sensor is set to dim level, as indicated in the "xx" portion of the part number, when the area is unoccupied. Example: BD20 sets the fixture to dim down to 20% lumen output when the area is unoccupied. Once motion is detected, the fixture will return to 100% light output. Sensor mounted off end cap of fixture.

BDxxPC

Factory set Bi-Level Dimming with motion and photocell. Sensor is set to dim level, as indicated in the "xx" portion of the part number, when the area is unoccupied and will not return to 100% light output unless 1. motion is detected and 2. the light level is below the preset level. Example: BD20PC sets the fixture to dim down to 20% lumen output when the area is unoccupied and will not return to 100% light output unless the above conditions are met for both motion and light level readings. Sensor mounted off end cap of fixture.

DHPC

Daylight Harvesting off photocell. Fixtures will continually dim up/down throughout the day based on light level readings taken from the photocell control. Sensor mounted off end cap of fixture.

Legrand FSP-311

FSP-311 offers fully adjustable high and low dimmed light levels with optional photocell. Hold off setpoint with automatic calibration option. Adjustable time delay and cut off delay. Sensor adjustable programming via iOS® or Android® 'Sensor Configuration' App. Sensor mounted on center driver channel.

Enlighted 5S/CU/IL

Bundled System with Enlighted 5E sensor (SU-5S-H-IL), Control Unit (CU-4E-FM) and Cable (CBL-5E-CU4-30N). Fixtures are controlled based on occupancy and ambient light. Includes ability to group fixtures together and connect to a switch to zone fixtures for group operation. Provided factory installed components only. Enlighted system provided by others. Contact factory for more information. Sensor mounted on center driver channel.

Enlighted 5S/CU/CL

Bundled System with Enlighted 5E sensor (SU-5S-H-CL), Control Unit (CU-4E-FM) & Cable (CBL-5E-CU4-30N). Fixtures are controlled based on occupancy & ambient light. Includes individual lighting control plus connection to Enlighted Energy Manager. The Energy Manager provides data analysis for all data collected by the Enlighted Smart Sensors for energy, occupancy & environment. Provided factory installed components only. Enlighted system provided by others. Contact factory for more information. Sensor mounted on center driver channel.

Enlighted 5S/CU/IOT

Bundled System with Enlighted 5E sensor (SU-5S-H-IOT), Control Unit (CU-4E-FM) and Cable (CBL-5E-CU4-30N). Fixtures are controlled based on occupancy and ambient light. Includes individual lighting control plus connection to Enlighted Energy Manager. The Energy Manager provides data analysis for all data collected by Enlighted Smart Sensors for energy, occupancy & environment. Additionally, the IOT functionality takes the data access and function beyond just lighting to a wide range of applications beyond the standard connected lighting controls. Provided factory installed components only. Enlighted system provided by others. Contact factory for more information. Sensor mounted on center driver channel.

ENDEAVOUR

LINEAR HIGH BAY

OPTIONS



CORDx

Cords available in 6ft, 10ft, 12ft & 20ft
(Inquire for additional options) Plug options available



QDCx

Quick Disconnect Cords available in 6ft, 10ft, 12ft & 20ft (Inquire for additional options) Plug options available.

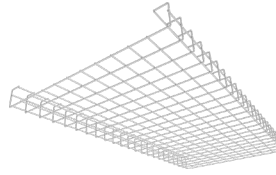

WC

11 GA Wire Cage

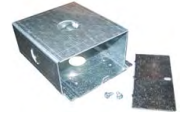

FMB

Includes rigid box to attach to the fixture, provides for single point mounting to accept a pendant, hook or conduit hub (sold separately)



HUB 3/4

Conduit Hub 3/4" for Pendant Mounting



HOOK

Cast Iron Hook for Single Point Mounting

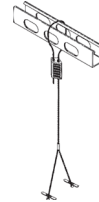

HB-XX-18Y-PAD

Includes 2 adjustable cable hangers. Available in 60", 120", 180" & 240"



SMBZKIT

Surface Mount Bracket Kit provides a 2" space above the fixture

LINE DRAWINGS

8L - 24L

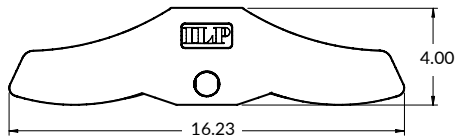
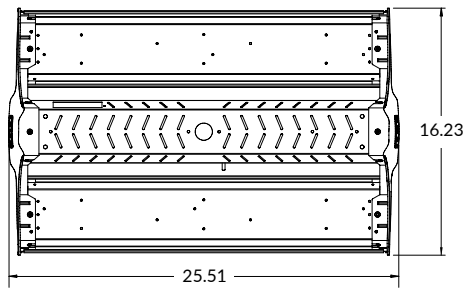

30L

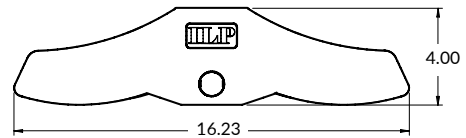
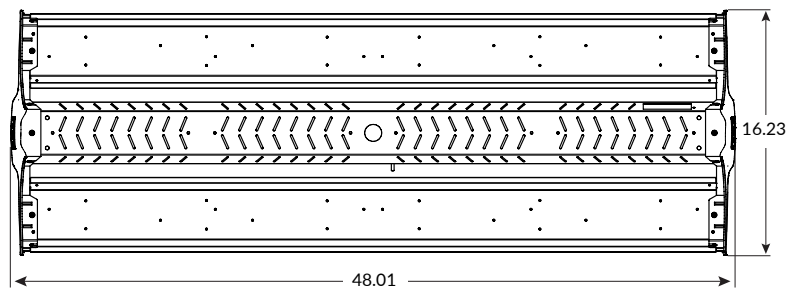

36L - 60L

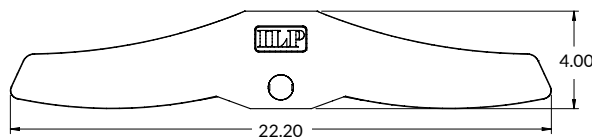
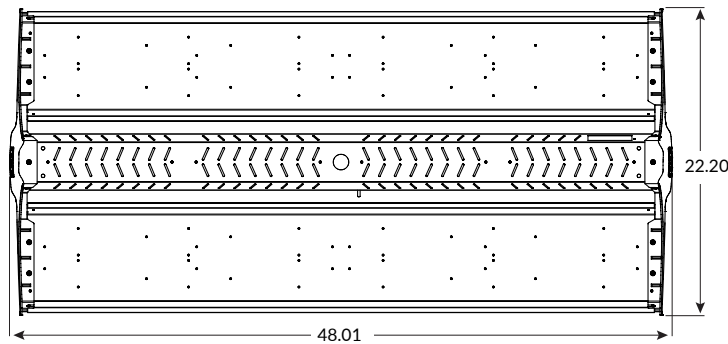

LINEAR HIGH BAY

PHOTOMETRIC DATA

LUMINAIRE DATA	
Part Number	EDV-24L-U-50
Description	Endeavour 2ft High Bay, 24000lm, without lens
Fixture Lumens (lm)	24,950 lm
Wattage (W)	164 W
Efficacy (lm/W)	152 lm/W
Mounting	Pendant
Spacing Criteria	0° = 1.27, 90° = 1.29

ZONAL LUMEN SUMMARY		
Zone	Lumens (lm)	% Fixture
0° - 40°	11,878	48%
0° - 60°	20,932	84%
0° - 90°	24,950	100%
90° - 180°	0	0%
0° - 180°	24,950	100%

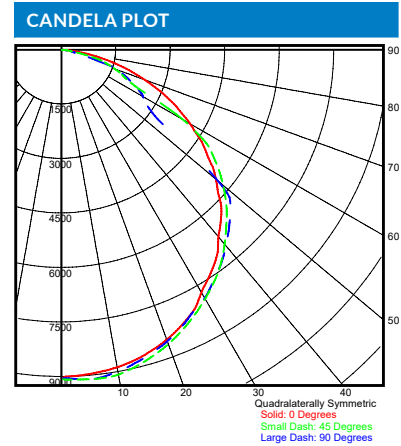

LUMINAIRE DATA	
Part Number	EDV-24L-U-50-FRL
Description	Endeavour 2ft High Bay, 24000lm, with frosted acrylic lens
Fixture Lumens (lm)	23,600 lm
Wattage (W)	163 W
Efficacy (lm/W)	145 lm/W
Mounting	Pendant
Spacing Criteria	0° = 1.24, 90° = 1.24

ZONAL LUMEN SUMMARY		
Zone	Lumens (lm)	% Fixture
0° - 40°	11,452	49%
0° - 60°	19,284	82%
0° - 90°	23,600	100%
90° - 180°	0	0%
0° - 180°	23,600	100%

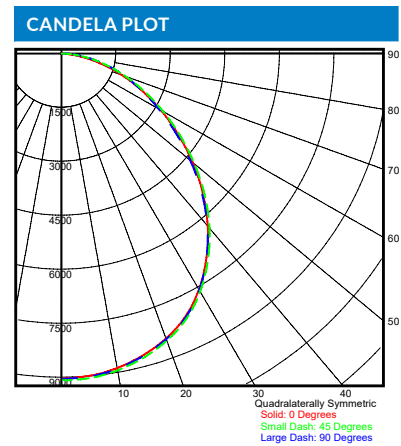

LUMINAIRE DATA	
Part Number	EDV-24L-U-50-FRL-UP/2L
Description	Endeavour 2ft High Bay, 24000lm, w/ frosted acrylic lens & 2000lm upright
Fixture Lumens (lm)	25,600 lm
Wattage (W)	176 W
Efficacy (lm/W)	145 lm/W
Mounting	Pendant
Spacing Criteria	0° = 1.24, 90° = 1.24

ZONAL LUMEN SUMMARY		
Zone	Lumens (lm)	% Fixture
0° - 40°	11,452	45%
0° - 60°	19,284	75%
0° - 90°	23,600	92%
90° - 180°	2,000	8%
0° - 180°	25,600	100%

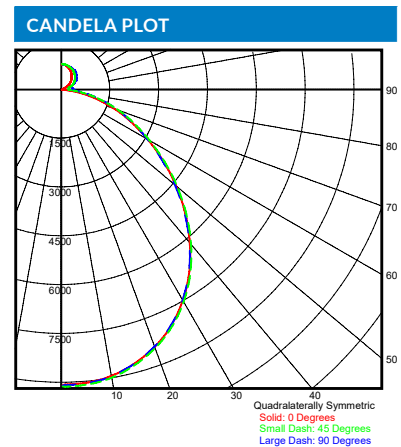

LUMINAIRE DATA	
Part Number	EDV-24L-U-50-FRL-ND
Description	Endeavour 2ft High Bay, 24000lm, with narrow distribution through a frosted acrylic lens
Fixture Lumens (lm)	21,780 lm
Wattage (W)	163 W
Efficacy (lm/W)	134 lm/W
Mounting	Pendant
Spacing Criteria	0 = 1.14 90 = 0.82

ZONAL LUMEN SUMMARY		
Zone	Lumens (lm)	% Fixture
0° - 40°	12,945	59.5%
0° - 60°	18,909	86.8%
0° - 90°	21,780	100%
90° - 180°	0	0%
0° - 180°	21,780	100%

