

# 2-Head Dusk-to-Dawn Security Light

# 2400 Max Lumen Security Light 2-Head Dusk-to-Dawn



3 Color Selectable  
**COLOR PREFERENCE®**

Hi-Lo Feature 50% brightness at dusk, 100% brightness when Motion detected

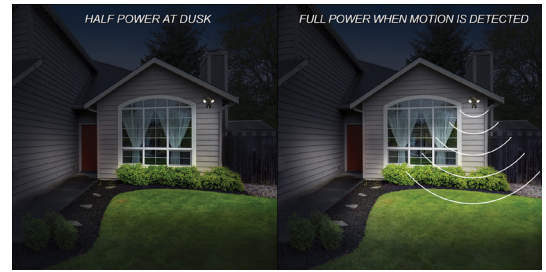

Model #: 51406111  
Bronze Finish

Model #: 51406112  
White Finish

28w 2-Head Security Light  
with Motion Sensor 28w,  
1200/2400 Lumen settings

**ETI** ADVANTAGE



Tool Less Adjustment



Patented Color Preference®  
3000K, 4000K, or 5000K



Fully Controllable

## AVAILABLE MODELS

### 28w 2-Head Security with Adjustable Motion Sensor

#### Bronze

Model #: 51406111

P/N: SC-2HD-2400LM-8-CP3-SV-BZ  
1200-2400 Lumens, Replaces 2x125w PAR

#### White

Model #: 51406112

P/N: SC-2HD-2400LM-8-CP3-SV-WH  
1200-2400 Lumens, Replaces 2x125w PAR

## Features & Specifications

- 28w, 1200 or 2400 Selectable Lumen output, replaces 2 125w PAR Lamps, 120V
- Adjustable Motion Sensor with timer or dusk-to-dawn operation
- Tool-less adjustability
- 3000K, 4000K, 5000K Color Preference®
- 50,000 hours of rated LED life
- Durable, all weather construction
- IP65 rated, suitable for wet location

# 2-Head Dusk-to-Dawn Security Light

Project:   
 Part Number:

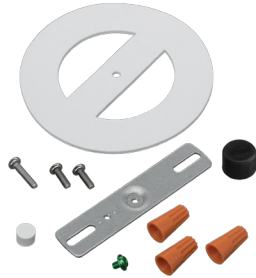

## PART NUMBER GUIDE

CATEGORY	# HEADS	LUMENS	CRI	CCT	VOLTAGE	FINISH
SC	2HD	2400LM	8	CP3	SV	

## PRODUCT/SKU DETAILS

### GENERAL SPECIFICATIONS:

Voltage	120VAC	Frequency	50/60 Hz.	CRI	80
Power Factor	>.90	THD	< 20%	Rating	cULus Wet
Temperature	-20°F to +113°F	Rated Life	50,000 hrs.	Warranty	5 Year Limited

## ORDERING GUIDE

Part #	Model #	Description	LED Watts	Lumens	Replaces	CRI	CCT	Product Dim.	Input Voltage	Case Pack
SC-2HD-2400LM-8-CP3-SV-BZ	51406111	28w Double Head Security Light w/ 3 CCT Color Preference®, Bronze finish	28w	2400 lm	2x 125w PAR	80	3000K/4000K /5000K	8.5 x 7.1 x 5.0 in.	120V	4
SC-2HD-2400LM-8-CP3-SV-WT	51406112	28w Double Head Security Light w/ 3 CCT Color Preference®, White finish	28w	2400 lm	2x 125w PAR	80	3000K/4000K /5000K	8.5 x 7.1 x 5.0 in.	120V	4

## PACKAGING SPECIFICATIONS

Part #	Model #	UPC	UCC	Inner Carton Dimensions	Inner Carton Weight	Shipper/Master Carton Dimensions	Shipper/Master Carton Weight
SC-2HD-2400LM-8-CP3-SV-BZ	51406111	849489064079	50849489064074	9.1 x 7.2 x 5.9 in.	2.90 lbs.	18.7 x 15 x 6.6 in.	12.7 lbs.
SC-2HD-2400LM-8-CP3-SV-WT	51406112	849489064086	50849489064081	9.1 x 7.2 x 5.9 in.	2.90 lbs.	18.7 x 15 x 6.6 in.	12.7 lbs.