

DATE:	PROJECT:
TYPE:	NOTES:
CATALOG #:	

LHB LIGHT WEIGHT
 ROUND HIGH BAY | E26 BASE
 12610 Delivered Lumens | 150W HID Equivalent

KEY FEATURES

ETi SSL's Ultra-Lightweight Round LED High Bay is only 2.5 lbs. and has three ways to mount: Suspension, E26 Adapter into Junction Box, or Lampholder Mount. Ideal for warehouses, loading docks, auto repair shops, showrooms, storage facilities, gyms, and more.

CCT & Light Quality

- 5000K, 80+ CRI
- CCT: 5000K

Light Output & Efficacy

- High Lumen Output: 12610 lumens
- Efficacy Rating: 133 LPW
- Lifetime rating 50,000 hrs.

Dimming, Voltage, Controls

- 0-10V dimming (only for suspension mounted)
- Universal voltage (120-277V), 50/60Hz

SPECIFICATIONS

Construction

- Housing: Die-cast aluminum
- Knockout holes for suspension mounting

Optics

- Frosted diffuse lens for reduced glare & visual comfort
- Shatter resistant lens for a variety of applications

Installation

- 3 Easy and flexible installation options included:

- **Suspension Mount** with included mounting chain and lifting hook
- **Speed Mount** using included E26 Lampholder and wire connectors
- **E26 Mount** into existing lamp holder

Electrical

- Operates at 120-277V, 50/60Hz
- 0-10V dimmable driver, down to 10% (only for suspension mounted)
- UL recognized drivers are rated for 50,000 hours
- Operating Temperature: -40°F (-40°C) to 113°F (45°C)

Warranty

5-Year Standard Warranty. See terms at: ETISSL.com/warranty/



KEY DATA	
Lumens	12610
Wattage	94.6
Efficacy (LPW)	133
Reported Life (Hours)	L70 / 50,000

Certifications & Test Data

- All luminaires are built to UL 1598 standards and have the appropriate UL labels and information on product (Search 502511XXX)
- Damp location rated
- Adheres to LM63, LM79, LM80 and TM21 industry standards for photometric, lumen maintenance and lifetime calculations
- Driver rated for FCC part 15 Class B for use in residential or commercial applications

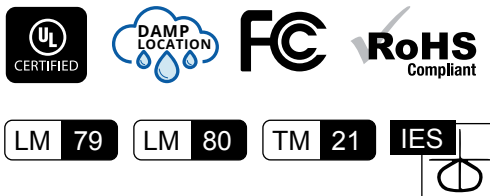

LHB Light Weight ROUND HIGH BAY | E26 BASE | 12610 DELIVERED LUMENS | 150W HID EQUIVALENT

CATALOG LOGIC

LHB	-	12IN	-	12000LM	-	8	-	50K	-	MV	-	LVD
Series		Size		Lumens		CRI		CCT		Voltage		Dimming
LHB Light Weight Round High Bay		12IN (12" Dia)		12000LM		8 80CRI (min.)		50K 5000K		MV Multi-Volt 120-277V		LVD 0-10V ¹

Notes:
1. 0-10V Dimming only when suspended mounting

STOCK ORDERING INFORMATION (typical 2-3 day shipment lead time)¹

Catalog Part Number	Order Number	Size (Dia)	Case QTY	Lumen Package	Delivered Lumens ²	Wattage (Nominal)	Efficacy	CCT	CRI	Voltage	Dim
LHB-12IN-12000LM-8-50K-MV-LVD	502511620	12.32"	4	12000	12610	100	133	5000K	80 (min)	120-277V	0-10V

Notes: 1. Stock SKUs typically ship in 24-48 hours upon receipt of an approved released order
2. For more delivered lumens and test data see below, or visit ETISSL.com

MOUNTING

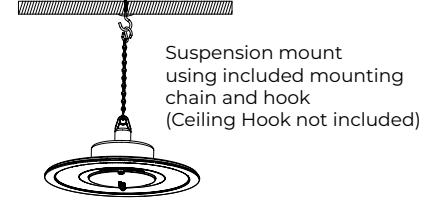
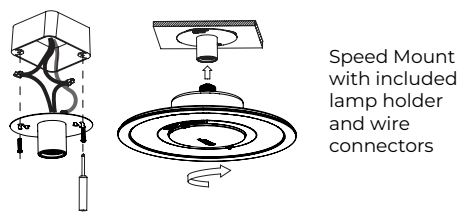
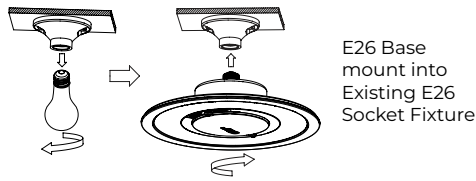

DIMENSIONS / DETAILS

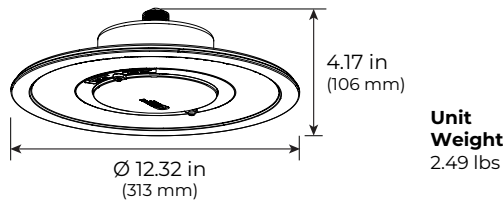

PERFORMANCE / DATA

Lumen Maintenance

Ambient Temp.	TM-21 Lumen Maintenance (54,000 hours)
25° C (77° F)	> 81%
Ambient Temp.	TM-21 Theoretical L70 (hours)
25° C (77° F)	50,000

Load Information

Power Factor	.90
THD	< 20%
Frequency	50/60 Hz
Low Temp Start / Max Temp	-40° C (-40° F) / 45° C (113° F)

PHOTOMETRIC SAMPLES



LHB-12IN-12000LM-8-50K-MV-LVD

Luminaire Data

CCT & CRI	5000K, 80CRI minimum
Initial Delivered Lumens	12610
Wattage	94.6W
Efficacy	133.0
Beam Angle	50° = 111° 10° = 153°
Spacing	0° = 1.28 90° = 1.28

Photometric values based on tests performed in compliance with LM-63 & LM-79

Indoor Candela Plot

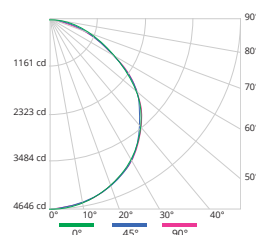

Zonal Lumen Summary

Zone	Lumens	% Luminaire
0-30	3631	28.8%
0-40	5966	47.3%
0-60	10467	83%
0-90	12542	99.5%
0-180	12610	100%