

Project: \_\_\_\_\_  
 Part#: \_\_\_\_\_  
 Type: \_\_\_\_\_

# Cusp Disk w/ PIR Sensor

**Closest Rated**

The EnVision ACCusp disk can be used in new construction and remodel applications. EnVisions new disk uses AC technology, features a slim aluminum body, with a translucent diffuser for reduced glare. EnVisions disk can be mounted into a 30 or a 40 J-Box giving it versatility and is a great solution that offers energy efficient and streamline design. Now equipped with a PIR sensor for motion detecting.

**Applications:**

- Residential Lighting
- Commercial Lighting
- Recessed Lighting
- General Indoor Lighting
- Ideal for use in closets

**Product Information:**

- Damp rated or wet rated (with silicone)
- Fits in standard 30 or 40 J-Box Applications
- Driver: AC Driverless technology 120V
- High CRI>90 with CA Title 24/CEC/T20 Compliance
- Dimmable: Compatible with most dimmers down to 5% including Lutron DVCL-153P
- Motion Sensor: Fixture turns off after 1 minute of no detection



**LED - C D S K - Size/Shape/Watts - T R I - W H - P I R - Warranty**

1
2
3
4
5
6

<b>1</b>	<b>Product</b>	<b>2</b>	<b>Size/Shape/Watts</b>	<b>3</b>	<b>Color</b>	<b>4</b>	<b>Trims</b>	<b>5</b>	<b>Sensor</b>	<b>6</b>	<b>Warranty</b>
LED-CDSK	Cusp Disk with PIR Sensor	4-10W 6-15W	4" / 10W (600lm) 6" / 15W (1000lm)	TRI	Switchable 30K / 40K / 50K	WH	White (incl.)	PIR	Motion Sensor	(Blank) 10YR	5 Year (incl.) 10 Year

*Specs and model numbers are subject to change with or without notice*

**FEATURES**

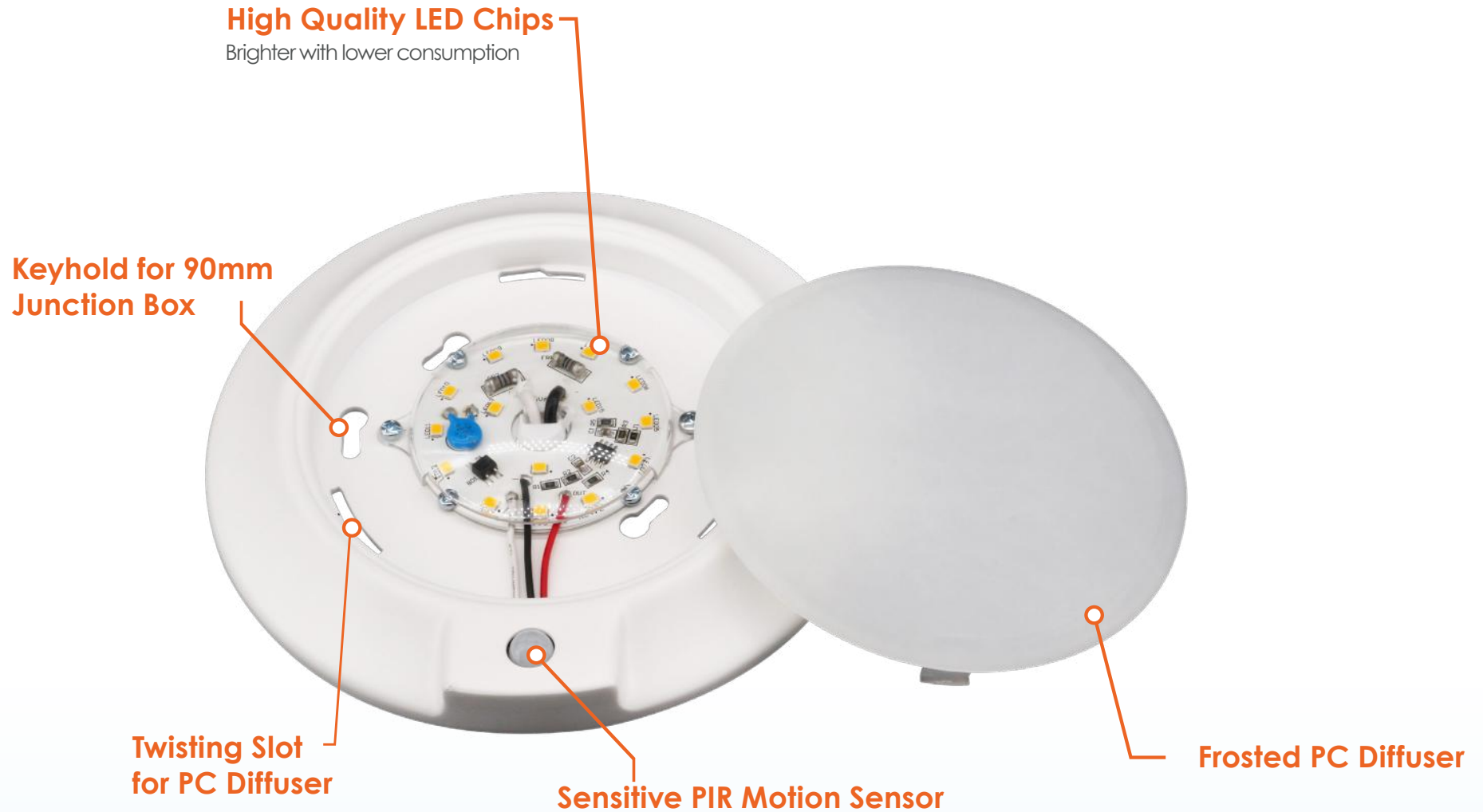

## INSTALLATION

The Cusp Disk PIR motion sensor lights provide surface mount light for new construction applications. Unit fits most 4" junction boxes and can replace 4", 5", 6" recessed can lights to eliminate baffles & fire rated boxes.

Step 1: Prior to installation, please install two screws (furnished) into the junction box. Do not drive screws completely to the end of the junction box.

Step 2: Connect supply wires to wires in fixture wiring box with proper size wire nuts or push wires into "push-in" connector. Connect white to white, black to black, and green or bare copper wire to bare copper wire.

Step 3: The ground wire at the service junction box may need to be secured to a ground screw.

Step 4: With a screwdriver, attach the disk light tightly to the j-box.

Step 5: Complete the installation by twisting the diffuser on the disk light metal enclosure and lock the diffuser in place.

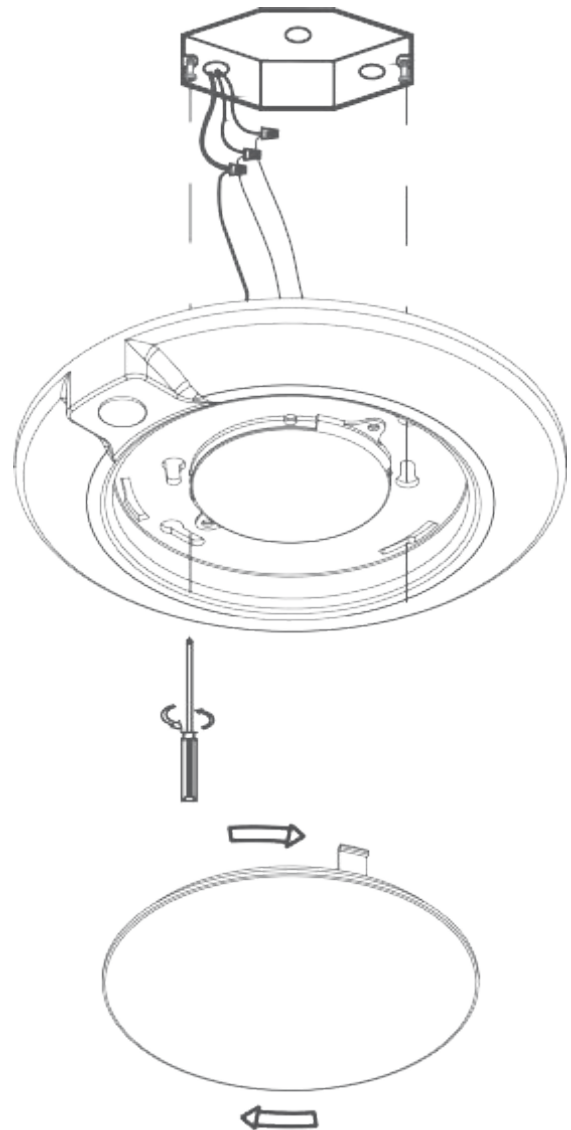

## DIMENSIONS

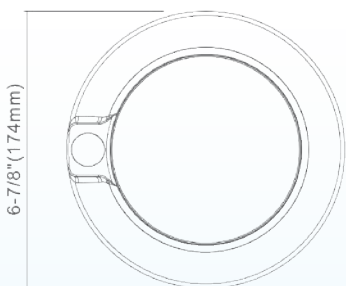

4"

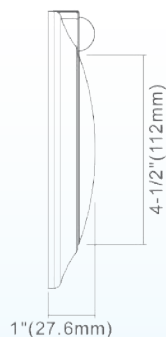

1" (27.6mm)

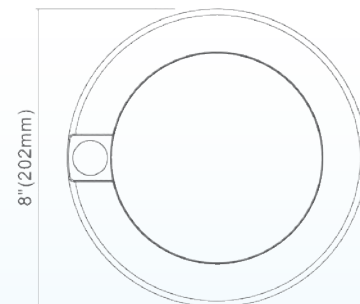

6"

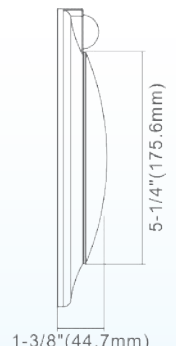

1-3/8" (44.7mm)