

Project: _____

Part#: _____

Type: _____

Universal Mounting Plate

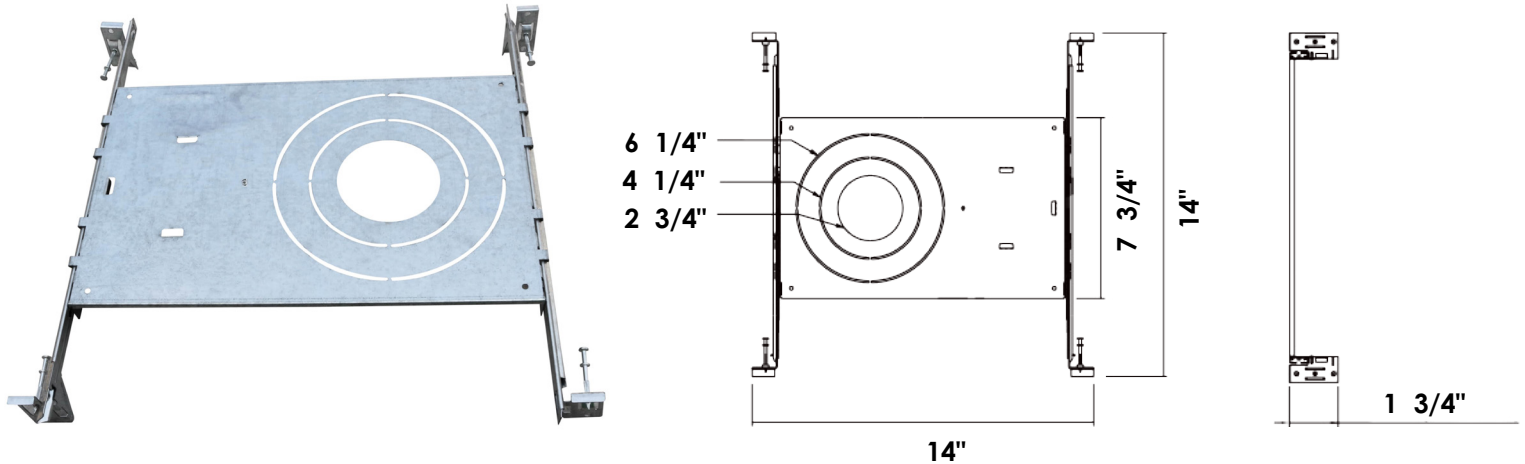

The EnVision LED Universal Mounting Plate, is a new construction pre-mounting plate with a collar for use with screw down "C" style remodel housings.

Applications:

- For use with "C" style remodel housings

Product Information:

- Multi-size: 2.5", 4" and 6"

C U N V - N C - I C A T

1

Product

CUNV-NC-ICAT Universal Mounting Plate

Specs and model numbers are subject to change with or without notice