

5
YEARS WARRANTY*



NEMO

LARGE MODEL LED FLOOD LIGHT

300W



IK08

MAXIMUM ENERGY SAVINGS

This high quality NEMO LED flood light is designed with the latest technology for optimal performance and is ideal for signs, accent architecture, flags, parking lots, and landscape lighting. LED technology has a longer life expectancy than fluorescent lighting, and emits no UV rays, contains no mercury, and does not flicker.



Greater light comfort, improved planning and more selection options for a wide spectrum of applications – the NEMO LED Floodlight range of luminaires has been specifically developed for wide-area and plaza lighting and sets new standards for complete building and facility lighting solutions.

► SLEEK DESIGN

Integrated aluminum material (ADC12) die-cast formation;
The surface is covered with black powder sprayed with special metal powder for outdoor use, which increases the dull polish concave-convex feeling and expands the heat dissipation area.
The SMD terminal can be pluggable and installed between the PCB board and the driver which is for the future maintenance (replacement of the driver or the PCB board);
Tempered glass adopts snap-on fixing method, which is convenient for future maintenance (To open the fixtures without tools).
The light-weight and ultra-thin design ensures light weight and is easy to transport and install under the premise of ensuring heat dissipation of the lamp;
The streamlined appearance has a small wind resistance coefficient, which is also conducive to air flow and heat dissipation;
The housing fixture is integrated of watertightness, and the waterproof level can reach Ip67;
The products has passed multiple certifications, ETL CE CB SAA ENEC IP66 IK08, salt spray test etc.

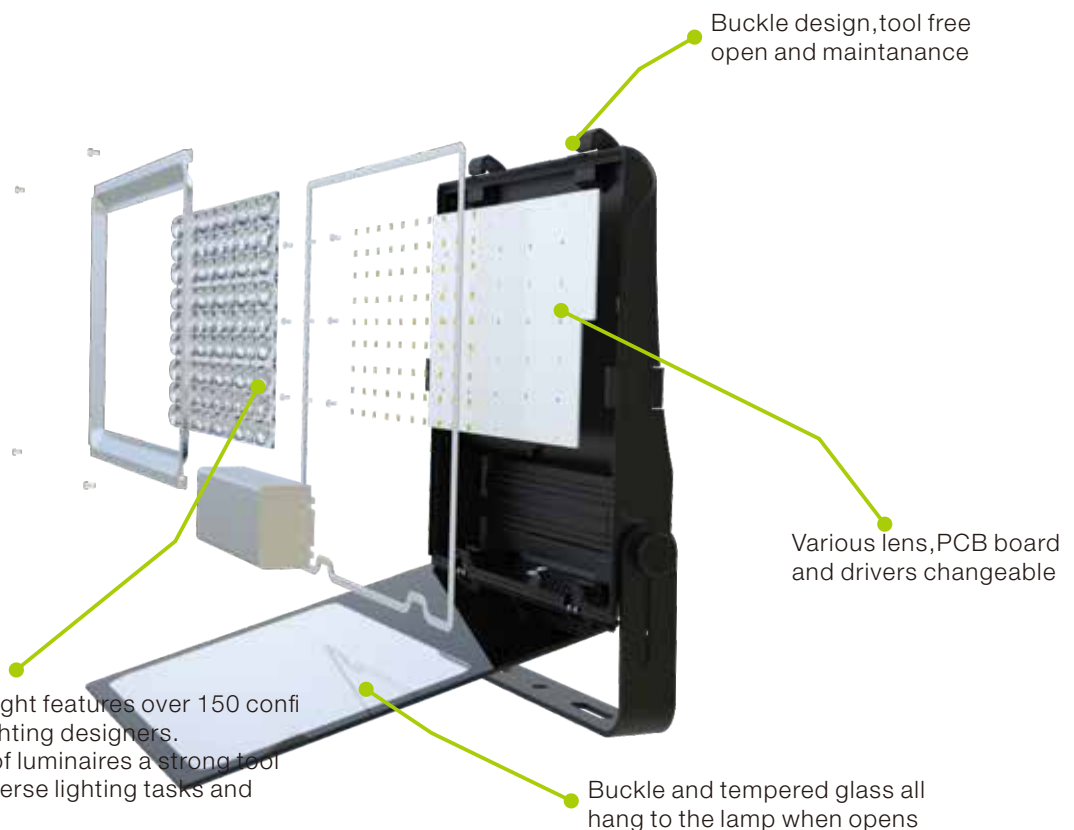

The NEMO LED Floodlight features over 150 configuration options for lighting designers. This makes the range of luminaires a strong tool for achieving highly diverse lighting tasks and specific targets.

SMALL MODEL 300W

STREET LIGHT SPECIFICATION SHEET

Product

Model (DLC NO.)	LSNFL-300W
Efficiency	155LM/W±3%
Luminous Flux (Photometered)	46500lm
Driver	2* XLG-150-H-A 2* SS-150GA-56
Beam Angle	10° 20° 60° 90° 120° 158°95° 49°21°
CCT	30K - 3000K 50K - 5000K 57K - 5700K 40K - 4000K
CRI	>70
Photocell	Optional

Electrical Characteristics (Luminaire)

Power Consumption	300W
Input Volt	100-277VAC / 200-240VAC
Frequency Range	47-63Hz
Power Factor	>0.95 / 230VAC
Total Harmonic Distortion	< 20%
Dimming Function	1 - 10V Continuous / PWM DALI Optional

Environmental

IP Rating	IP66
Impact Rating	Ik08
Salt Spray Tested	Yes
Operating Temp. Range	-30° ~ 122°F (-30° ~ 45°C)
Operating Humidity	15 - 90%
Thermal Management Type	Natural air cooling
Expected Lifespan	50,000 Hours to 70% Brightness
Material Composition (Body)	ADC-12 Aluminium Alloy (<0.1% copper content)
Material Composition (Optics)	PMMA (UV Resistance)
Material Composition (Cover)	Extra clear tempered glass protect
Mounting/Bracket Type	Post-top position, Side-entry position
Cable Gland	Pg11(Stainless steel)
Cable Ø Entry Range	10 -14mm

Product

Model	LSNFL-300W
Weight/Packaging	
Luminaire Weight	441x357x60mm
Packaging Dimensions	570x510x130mm
Packaged Weight	7.0Kg

Certificates (Safety Standards)

ETL		✓
DLC(Standard)		✓
ENEC	IEC/EN60598-2-3	✓
CB	IEC/EN60598-1	✓
TUV CE-LVD	IEC/EN62778	✓
Australian deviation		✓
TUV CE-EMC	EN55014 EN61547 EN61000-3-2 EN61000-3-3	✓
SAA		✓
TUV IK08		✓
Salt Spray Test	24H	✓
IP66	By ENEC	✓
Flammability test	By ENEC	✓

Warranty

Warranty

5 years extended warranty optional

▼ DIMENSIONS

Length: 15.23 in (477mm)	Height: 20.39 in (518mm)
Width: 2.36 in (60 mm)	Height (Including Bracket): 20.39 in (518 mm)
	Height (Not including Bracket): 16.92 in (430 mm)

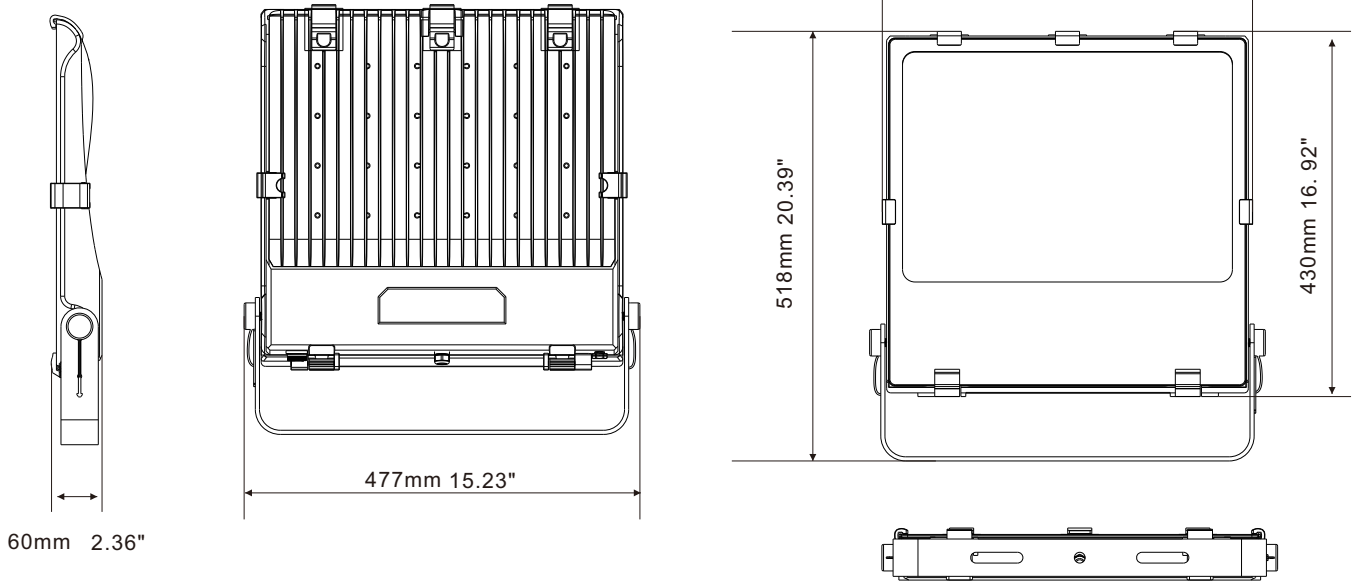

▼ MOUNTING OPTIONS

A Variety of installation methods to meet your needs

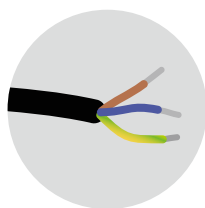

▼ PHOTOMETRIC OPTIONS

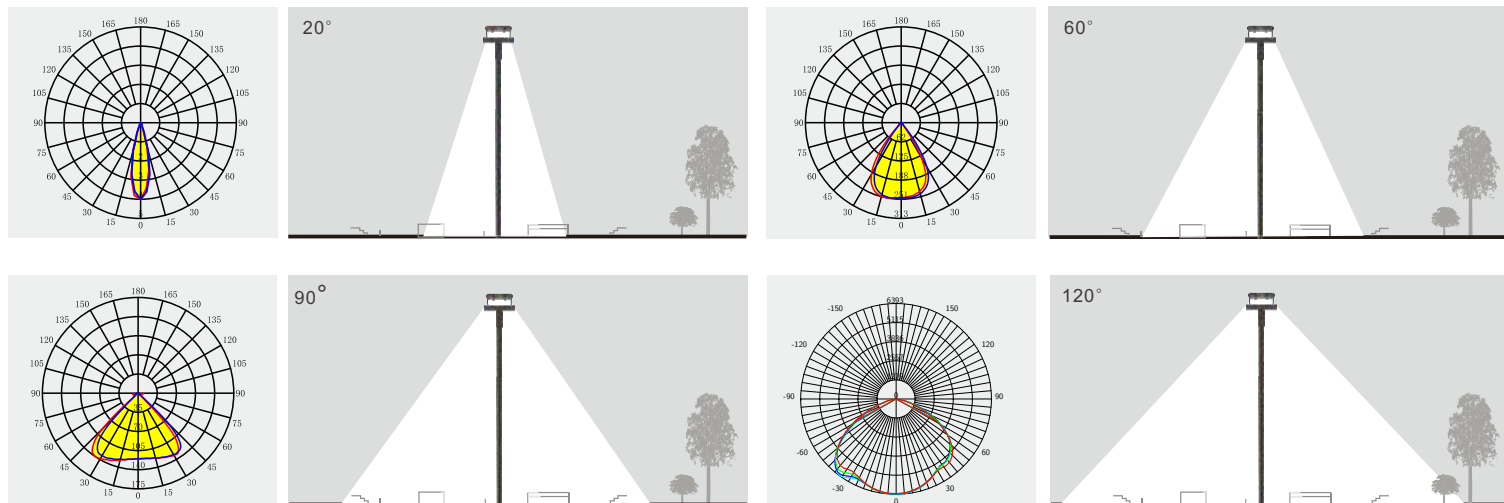

Special for tennis court (Anti-Glaring)

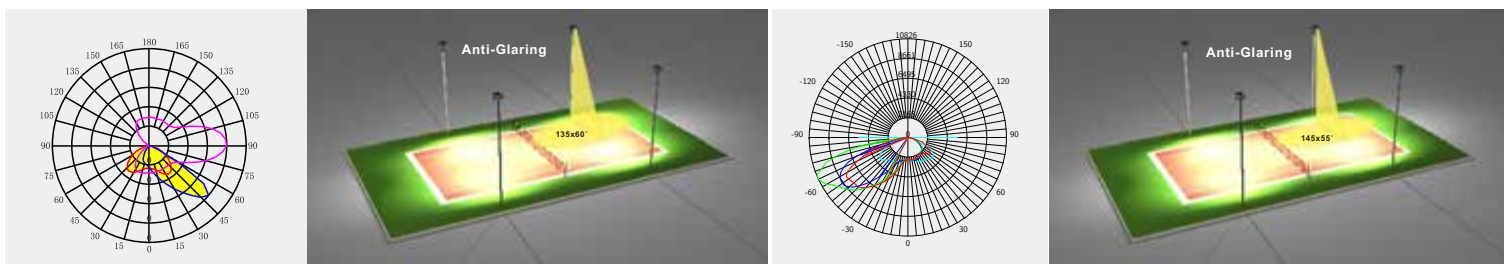

▼ ORDERING EXAMPLE

NEMO LED FLOOD LIGHT

LSNFL - XXW - (XXK)

3000K
4000K
5000K
5700K

Wattage
100W 150W 200W 240W 300W

Product Family
LS- Lamp shining
NFL- NEMO LED Flood Light

► ACCESSORY: PHOTOCELL

This fixture is optional with photocell sensor

- Photocell integration controls
120-277Volt
Optional



► ACCESSORY: SURGE PROTECTION DEVICE

This fixture is optional with 10KV or 20KV SPD.

SPD surge protection devices is perfectly adapted for outdoor lighting to provide single phase protection for line/neutral, line/ground and neutral/ground in accordance with IEEE C62.41 2002 C High, UL1449 and IEC61643-11



Optional